



## 2 Rutherford Close, Abingdon

Abingdon

**Simpsons**  
The Proactive Agent

Guide Price **£550,000**



SCAN THE  
QR CODE  
FOR DETAILS



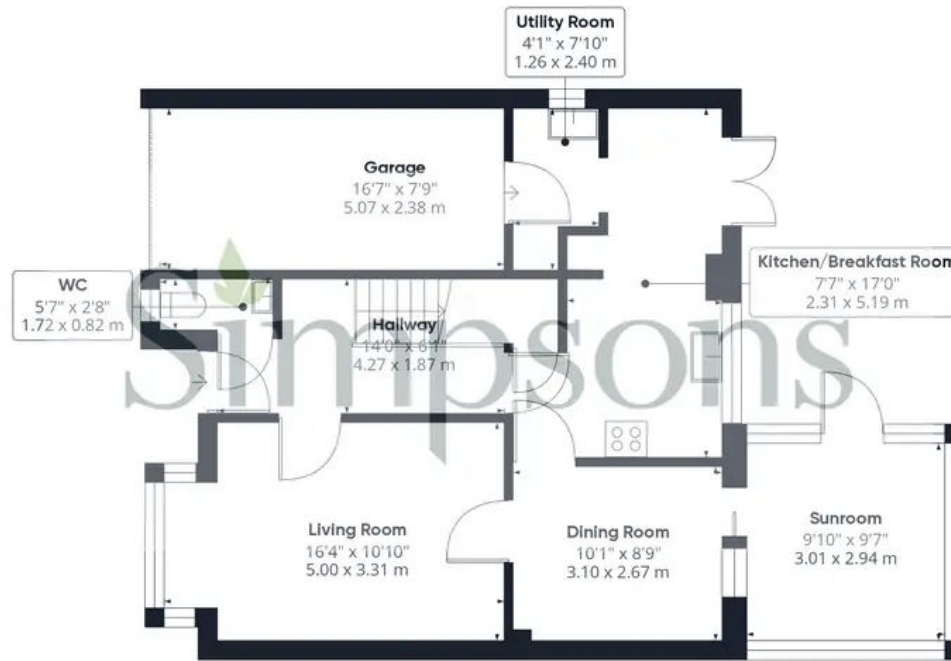

Approximate total area<sup>(1)</sup>  
1166.19 ft<sup>2</sup>  
108.34 m<sup>2</sup>



(1) Excluding balconies and terraces

While every attempt has been made to ensure accuracy, all measurements are approximate, not to scale. This floor plan is for illustrative purposes only.

# 2 Rutherford Close

Abingdon, Abingdon

A stunning family home in a highly regarded cul de sac in North Abingdon.

Council Tax band: E

Tenure: Freehold

- A larger design, three bedroom detached home offered for sale in immaculate condition with the added benefit of no onward chain.
- Superbly appointed, refitted kitchen with hi-gloss finish and stone worksurfaces.
- Master bedroom with built in wardrobe and en-suite shower room.
- Brick built, double glazed sun room extension.
- Block paved driveway parking and gated garden access.
- Low maintenance rear garden, newly installed fencing and block paved patio.
- Three reception rooms.
- Rush Common Primary School catchment, also being within a very short walk.



SCAN THE  
QR CODE  
TO BOOK  
YOUR VIEWING



