



6 Hound Close, Abingdon

Abingdon

Simpsons
The Proactive Agent

£550,000



SCAN THE
QR CODE
FOR DETAILS



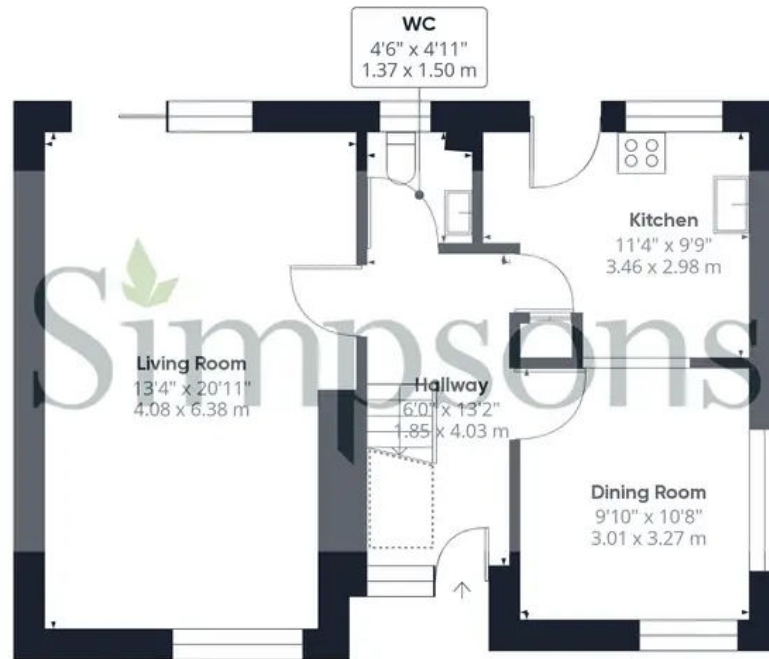

Floor 0

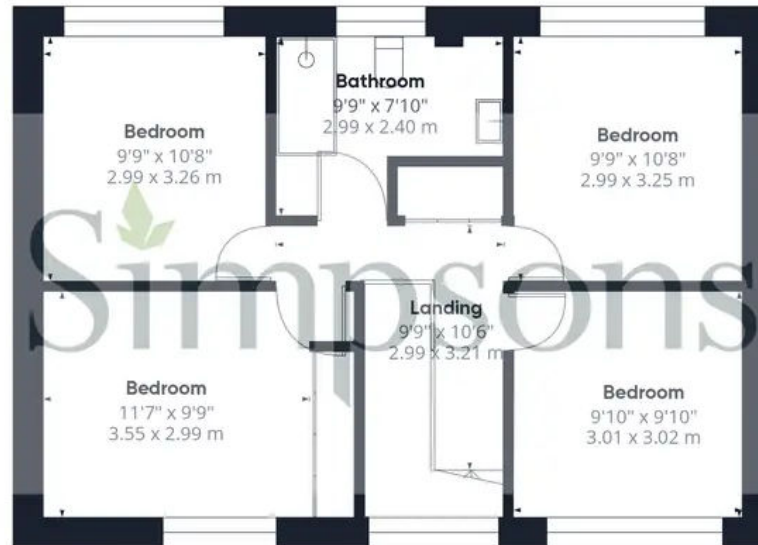

Floor 1

Approximate total area⁽¹⁾

1168.08 ft²

108.52 m²

Reduced headroom

16.38 ft²

1.52 m²

(1) Excluding balconies and terraces

☒ Reduced headroom
(below 1.5m/4.92ft)

While every attempt has been made to ensure accuracy, all measurements are approximate, not to scale. This floor plan is for illustrative purposes only.

GIRAFFE360

6 Hound Close

Abingdon, Abingdon

A larger design family home in a private cul de sac, offering privacy from neighbouring homes. No onward chain.

Council Tax band: E

Tenure: Freehold

- For sale with no onward chain, a larger design four bedroom home with a detached double garage.
- Four double bedrooms.
- Larger than average plot with well kept front and rear gardens.
- Separate dining room and front to back sitting room overlooking the front and rear garden.
- Rush Common Primary School catchment area, walking distance to Peachcroft shops and bus routes serving the Town Centre and Oxford City.
- Potential to extend to the side and rear.



SCAN THE
QR CODE
TO BOOK
YOUR VIEWING



