



2 Barton Court, Drayton

Abingdon

Simpsons
The Proactive Agent

Guide Price **£315,000**



SCAN THE
QR CODE
FOR DETAILS



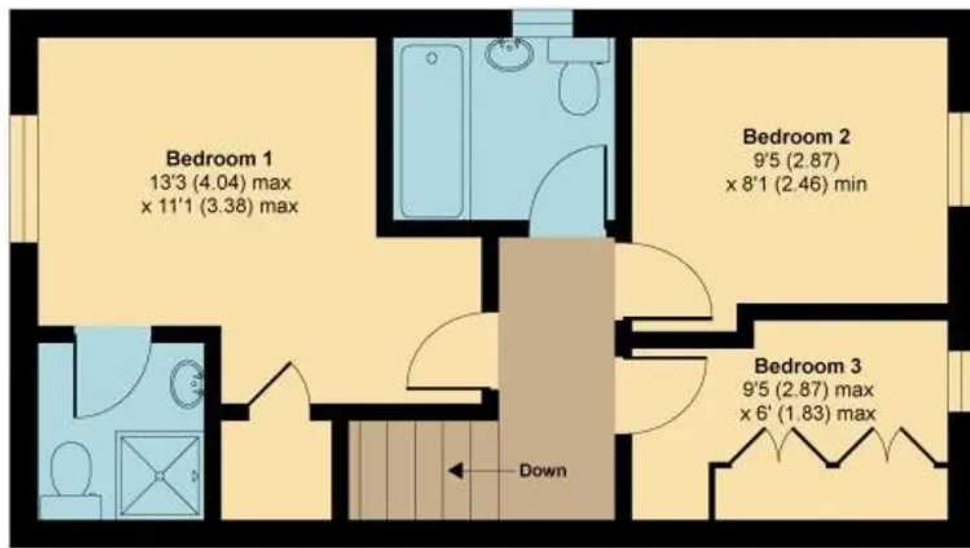

FIRST FLOOR

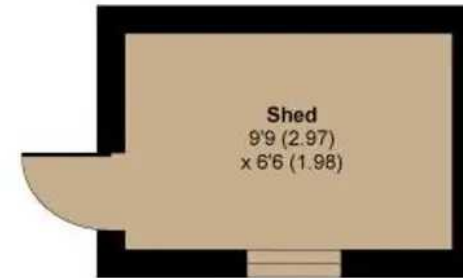

OUTBUILDING



GROUND FLOOR

Barton Court, Drayton, Abingdon, OX14

MAIN HOUSE APPROX. GROSS INTERNAL FLOOR AREA 806 SQ FT 74.9 SQ METRES
 OUTBUILDING APPROX. GROSS INTERNAL FLOOR AREA 64 SQ FT 5.9 SQ METRES
 TOTAL APPROX. GROSS INTERNAL FLOOR AREA 870 SQ FT 80.8 SQ METRES

2 Barton Court

Drayton, Abingdon

Chain-free modern three bedroom family home tucked away in a small cul de sac in the heart of Drayton village. Benefitting from a downstairs WC, enclosed rear garden, and two allocated parking spaces with EV charger.

Council Tax band: C

Tenure: Freehold

- Three bedrooms, including a master bedroom with an en-suite shower room.
- Cosy sitting room with feature wood panelling.
- Useful downstairs WC.
- Open plan kitchen/diner with French doors opening into the garden.
- Two allocated parking spaces with 7kw EV charger to the immediate front of the property.
- Located within a few miles of Milton Park, Culham Science Centre, and Harwell's Scientific establishments.
- No onward chain.



SCAN THE
QR CODE
TO BOOK
YOUR VIEWING



