



## Flat , West St. Helen Street, Abingdon

Guide Price £175,000

Abingdon

**Simpsons**

The Proactive Agent



SCAN THE  
QR CODE  
FOR DETAILS



GROUND FLOOR  
409 sq.ft. (38.0 sq.m.) approx.

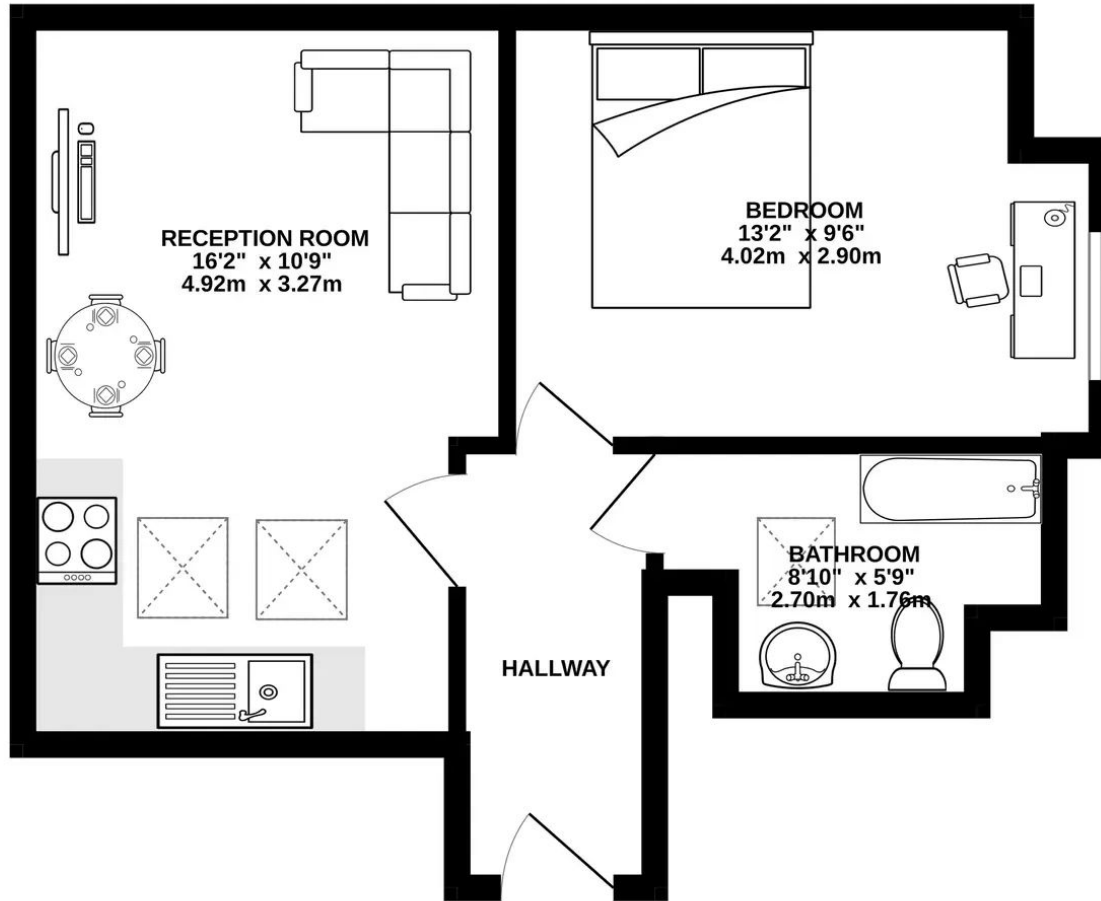

TOTAL FLOOR AREA : 409 sq.ft. (38.0 sq.m.) approx.

Whilst every attempt has been made to ensure the accuracy of the floorplan contained here, measurements of doors, windows, rooms and any other items are approximate and no responsibility is taken for any error, omission or mis-statement. This plan is for illustrative purposes only and should be used as such by any prospective purchaser. The services, systems and appliances shown have not been tested and no guarantee as to their operability or efficiency can be given.  
Made with Metropix ©2023



# Flat

West St. Helen Street, Abingdon

This second floor, one bedroom 'loft' apartment is located on West St Helen Street in Abingdon town centre.

Council Tax band: B

Tenure: Leasehold

- A unique second floor apartment in a historic town centre building, converted to apartments in 2007.
- £450 per year maintenance fee and £150 per year ground rent. 107 Year leasehold term remaining.
- Electric flow boiler wet central heating system for radiators and hot water.
- Resident parking permit eligibility for On-Street and at West St Helen St Car Park
- Offered for sale with no onward chain / vacant possession
- Rental value approx. £850 per month.



SCAN THE  
QR CODE  
TO BOOK  
YOUR VIEWING





