



Jackman Close, Abingdon, OX14

£185,000 in excess

Property Description

Purchase with a tenant in situ, yielding 5%+. This first-floor apartment is situated in the popular development of Jackman Close, and is within easy reach of the town centre along with many nearby amenities.

Purpose-built, the property has to offer an open-plan living room / kitchen; a modern bathroom suite; plus two bedrooms, with a fitted built-in wardrobe to the master. The property also benefits from electric night storage heating, allocated and visitor parking, plus well-kept communal grounds.

EPC Rating: C



Key Features

- ✓ Investors Only
- ✓ Ground rent £200 per year, Service Charge £1435 per year
- ✓ No Onward Chain
- ✓ Two Bedrooms
- ✓ Allocated Parking
- ✓ First Floor Apartment







All

521 sq.ft. (48.4 sq.m.) approx.

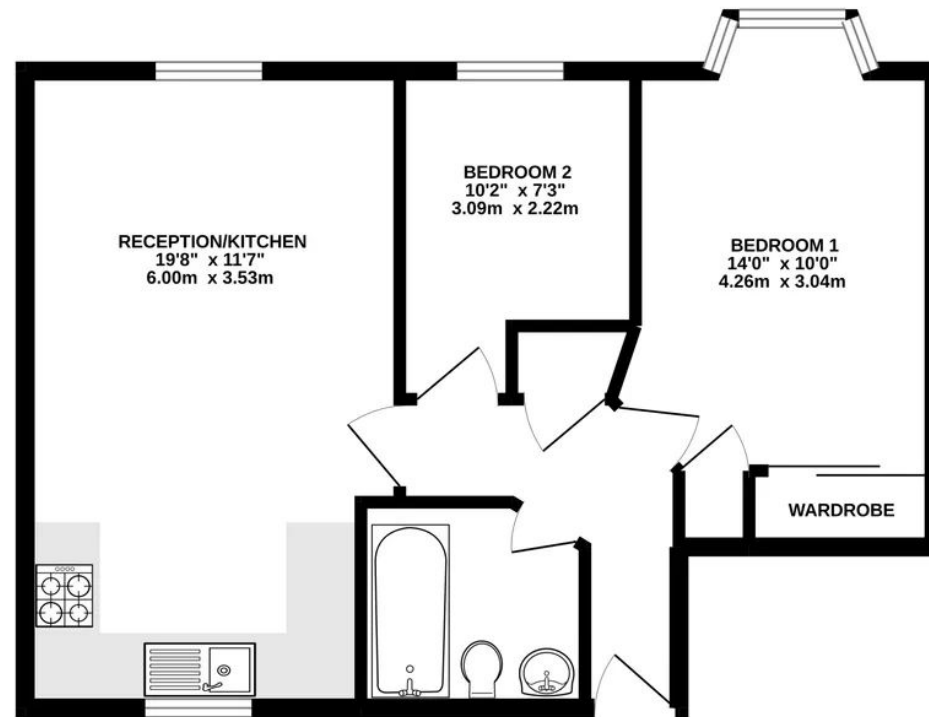

TOTAL FLOOR AREA: 521 sq.ft. (48.4 sq.m.) approx.

Whilst every attempt has been made to ensure the accuracy of the floorplan contained here, measurements of doors, windows, rooms and any other items are approximate and no responsibility is taken for any error, omission or mis-statement. This plan is for illustrative purposes only and should be used as such by any prospective purchaser. The services, systems and appliances shown have not been tested and no guarantee as to their operability or efficiency can be given.
Made with Metropix ©2022

Simpsons Estate Agents

01235520079

abingdon@simpsonsproperty.com

