



15 Bergamot Place, Oxford

Oxford

£365,000

Simpsons

The Proactive Agent

Bergamot Place - Oxford

Approximate Gross Internal Area = 66.1 sq m / 711 sq ft
(Including Void)

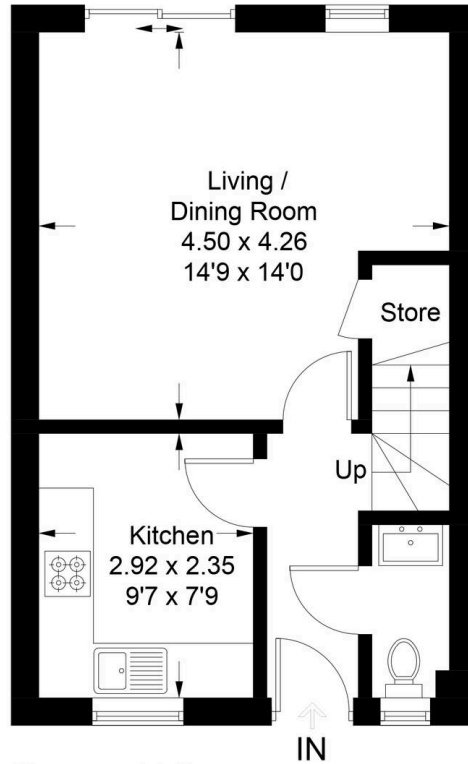

Ground Floor

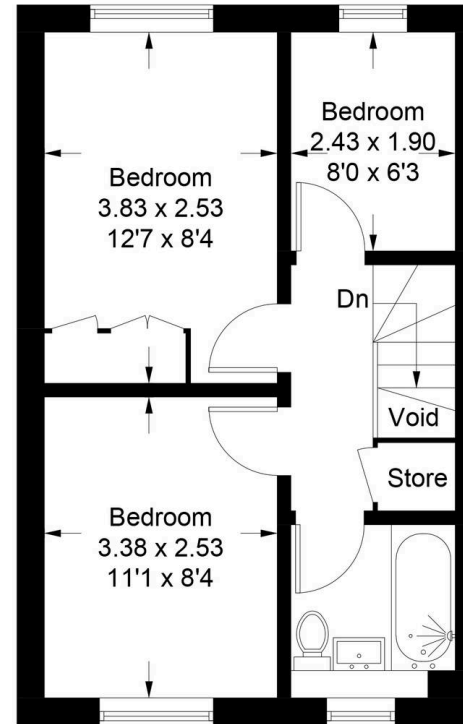

First Floor

15 Bergamot Place

Oxford

Council Tax band: C

Tenure: Freehold

- Attractive three-bedroom end-of-terrace family home in a popular residential location.
- No onward chain.



SCAN THE
QR CODE
TO BOOK
YOUR VIEWING

