



**4 Maria Crescent, Wantage**

Wantage

Guide Price **£385,000**

**Simpsons**

The Proactive Agent

# Maria Crescent - Wantage



Approximate Gross Internal Area = 87.0 sq m / 936 sq ft

Garage / Shed = 16.0 sq m / 172 sq ft

Total = 103.0 sq m / 1108 sq ft

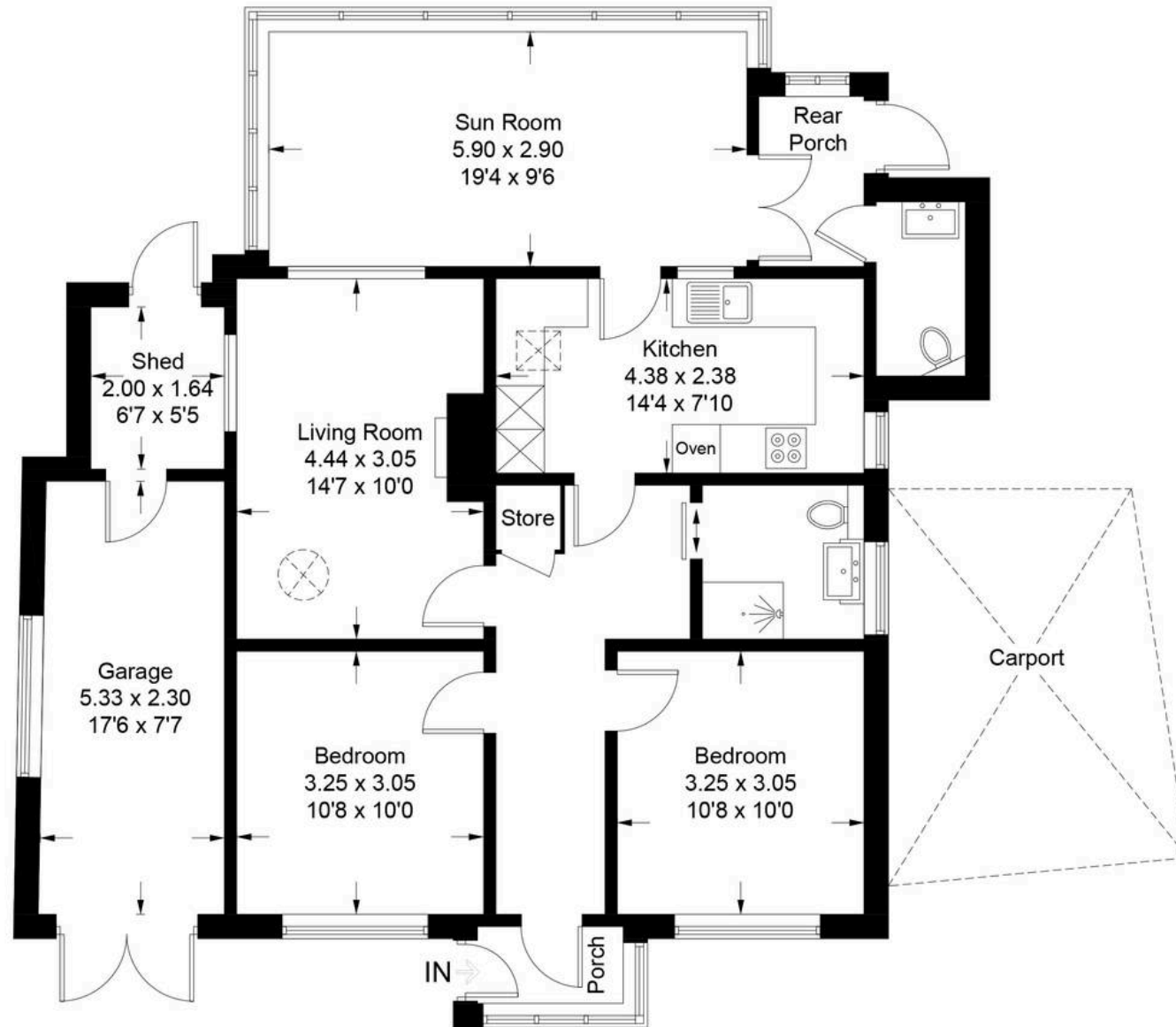

Illustration for identification purposes only, measurements are approximate,  
not to scale. Fourlabs.co © (ID1237169)

# 4 Maria Crescent

Wantage, Wantage

Council Tax band: D

Tenure: Freehold

- No Chain
- Scope To Improve (STP)
- Walking Distance to Market Place
- Quiet Cul-De-Sac



SCAN THE  
QR CODE  
**TO BOOK**  
YOUR VIEWING

