



3 Mary Whipple Court, Wantage

Wantage

Guide Price **£260,000**

Simpsons

The Proactive Agent

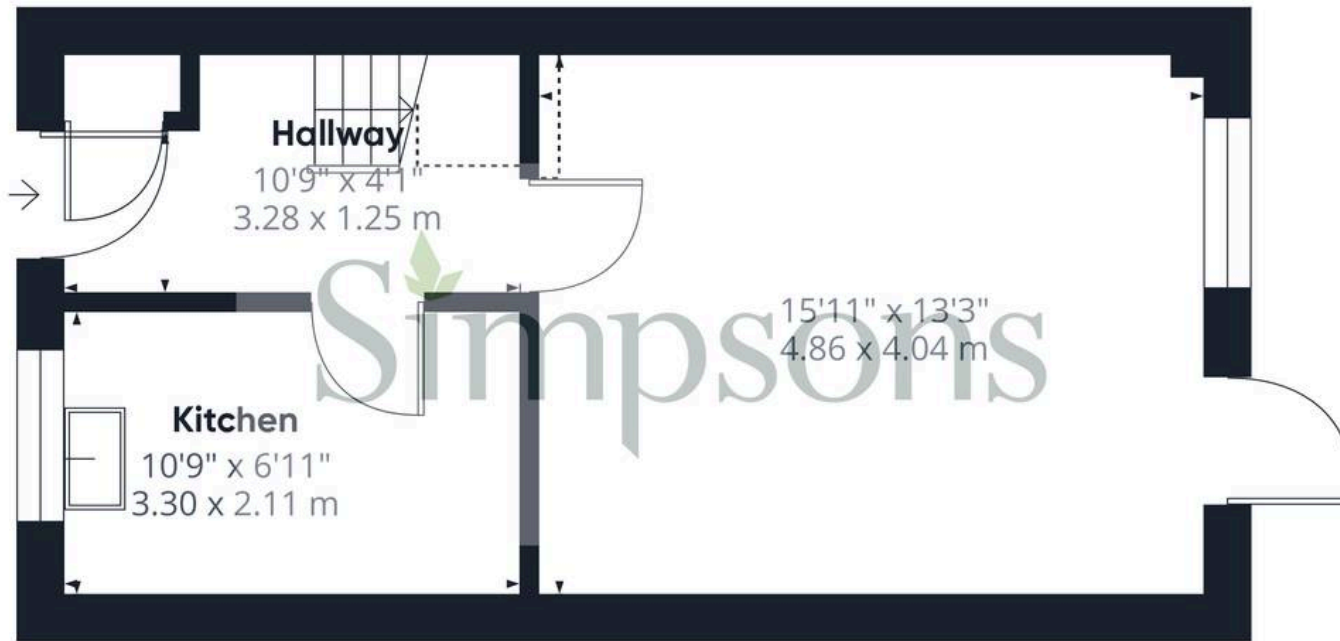

Floor 0

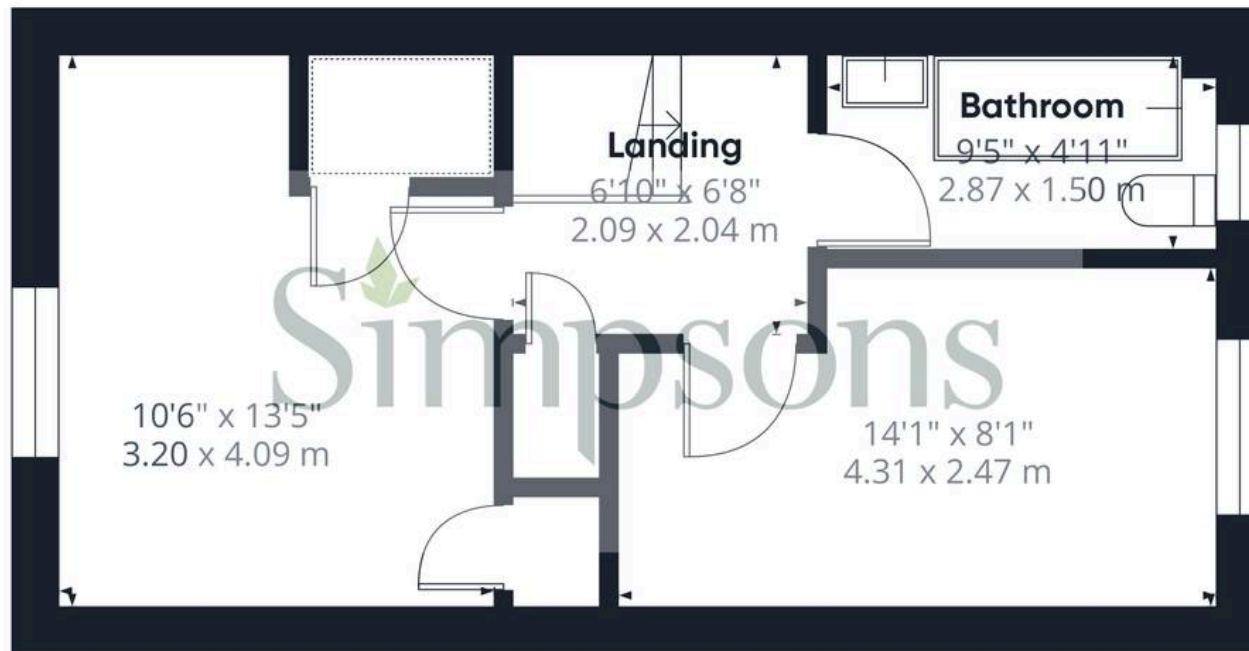

Floor 1

Approximate total area⁽¹⁾

667 ft²

62.2 m²

Reduced headroom

8 ft²

0.7 m²

(1) Excluding balconies and terraces

Reduced headroom

..... Below 5 ft/1.5 m

Calculations reference the RICS IPMS 3C standard. Measurements are approximate and not to scale. This floor plan is intended for illustration only.



3 Mary Whipple Court

Wantage, Wantage

This well-presented two-bedroom terraced house is offered to the market with no onward chain, providing an excellent opportunity for a quick and straightforward move.

Council Tax band: C

Tenure: Freehold

- No Onward Chain For A Quick & Easy Move
- Scope To Enhance & Redesign
- Allocated Off-Street Parking
- Walking Distance To Wantage Market Place



SCAN THE
QR CODE
TO BOOK
YOUR VIEWING



