



17 Whitworth Way, Grove

Wantage

£283,000

**Simpsons**

The Proactive Agent

Approximate Area = 644 sq ft / 59.8 sq m  
Outbuilding = 23 sq ft / 2.1 sq m  
Total = 667 sq ft / 62 sq m  
For identification only - Not to scale

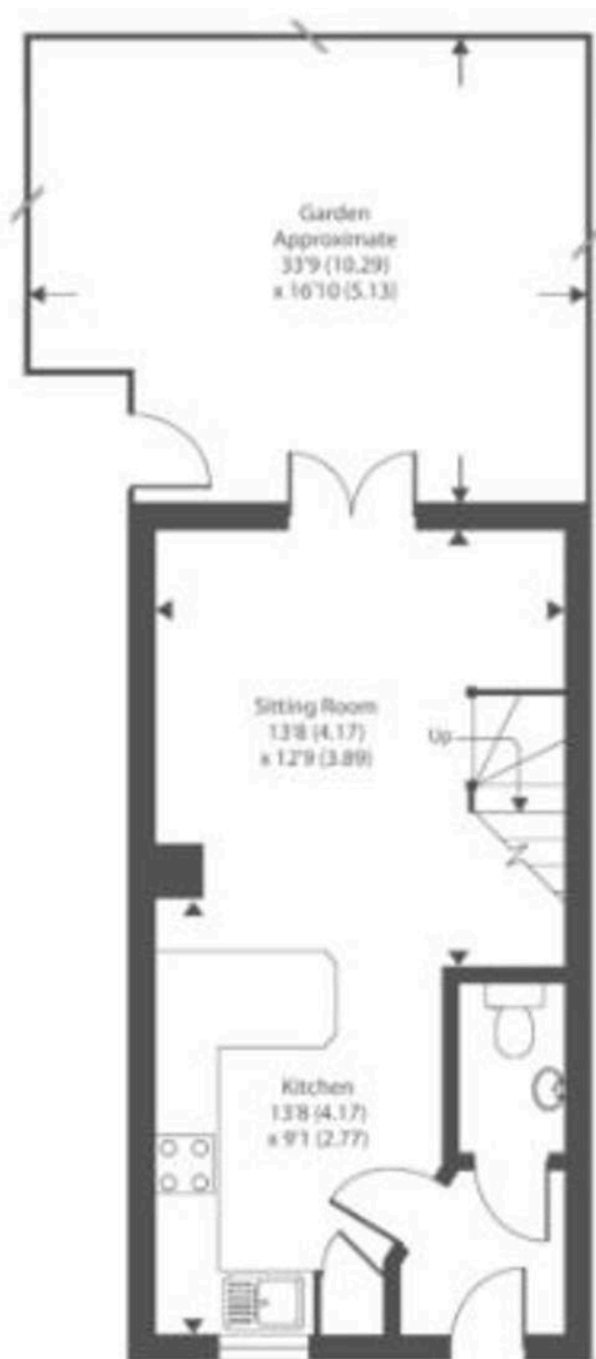

Ground floor

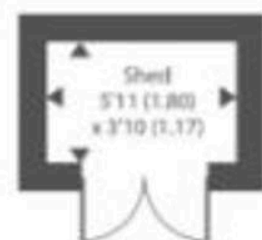

First floor

# 17 Whitworth Way

Grove, Wantage

Council Tax band: C

Tenure: Freehold

- Immaculately presented two bedroom semi detached property.
- Perfect for first time buyers or investors.
- Close to local shops and amenities.
- Side by side parking for multiple vehicles.
- 7 years left on the NHBC warranty.



SCAN THE  
QR CODE  
TO BOOK  
YOUR VIEWING

