



15 Trenchard Avenue, Milton

Abingdon

£250,000

Simpsons
The Proactive Agent

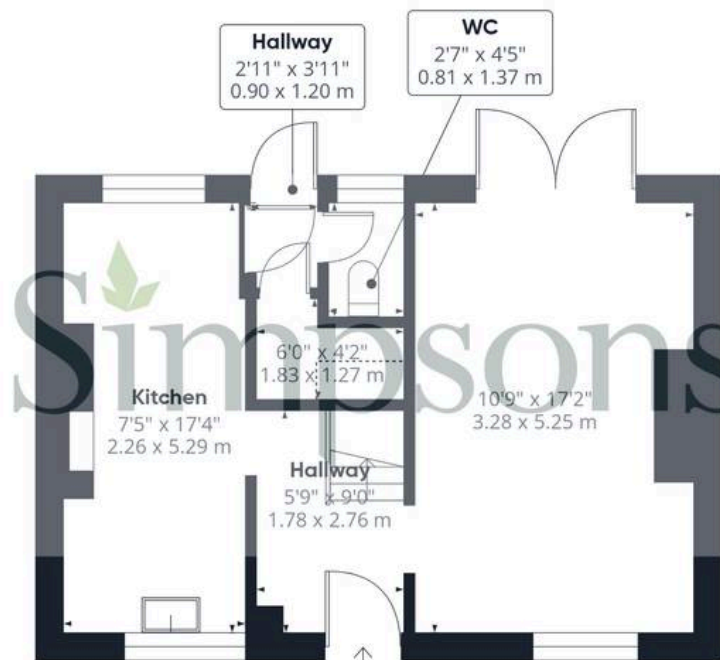

Floor 0

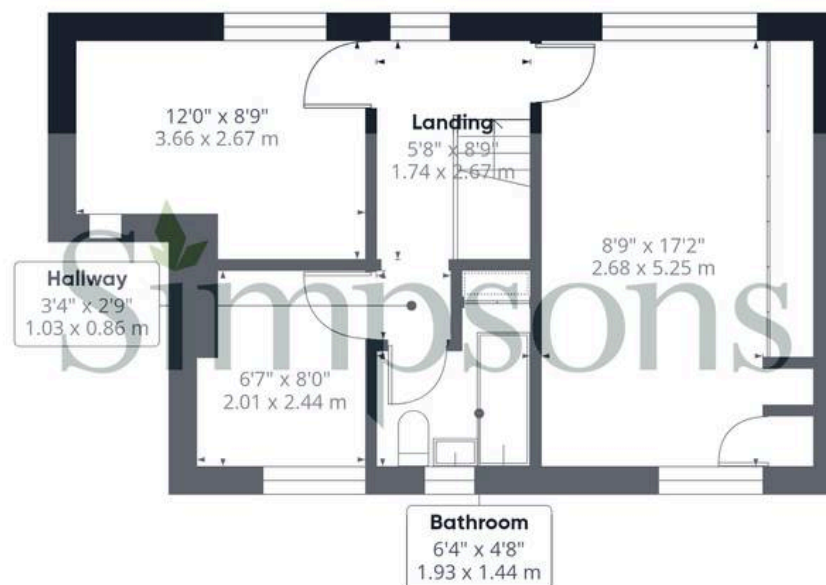

Floor 1



Approximate total area⁽¹⁾

828 ft²

76.8 m²

Reduced headroom

4 ft²

0.4 m²

(1) Excluding balconies and terraces

Reduced headroom

Below 5 ft/1.5 m

Calculations reference the RICS IPMS 3C standard. Measurements are approximate and not to scale. This floor plan is intended for illustration only.

GIRAFFE360

15 Trenchard Avenue

Milton, Abingdon

An exciting opportunity to add value and make your own, this three bedroom home is located on Trenchard Avenue in Milton, near to Didcot. The property is offered to the market with no onward chain.

Council Tax band: C

Tenure: Freehold

- No onward chain
- Walking distance to Milton Park and nearby bus routes including the X2 that takes you between Oxford, Abingdon & Didcot.
- The property is located on Trenchard Avenue, with on street parking only.
- This three bedroom home offers buyers the exciting opportunity to make it their own, in need of some cosmetic updating.
- Rear gated access, offering the potential of off street parking.
- Gas central heating



SCAN THE
QR CODE
TO BOOK
YOUR VIEWING



