



32 Hilliat Fields, Drayton

Abingdon

In Excess of **£275,000**

Simpsons
The Pro**active** Agent

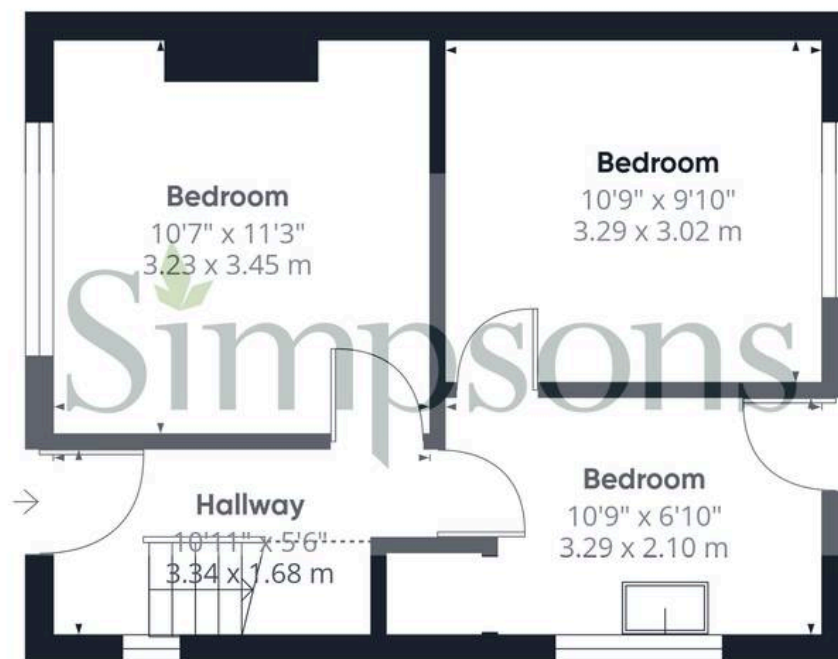

Floor 0



Floor 1

Approximate total area⁽¹⁾

690 ft²

64.1 m²

Reduced headroom

15 ft²

1.4 m²

(1) Excluding balconies and terraces

Reduced headroom

Below 5 ft/1.5 m

Calculations reference the RICS IPMS 3C standard. Measurements are approximate and not to scale. This floor plan is intended for illustration only.

GIRAFFE360

32 Hilliat Fields

Drayton, Abingdon

Located in the village of Drayton, a semi detached home with scope to improve and extend, subject to planning.

Council Tax band: C

Tenure: Freehold

- Located in the village of Drayton, backing on to a extensive farm land with far reaching views and a larger than average rear garden.
- Subject to planning consent, scope to extend the accommodation, improve and add value.
- Walking distance to Drayton Primary School, the village convenience store and The Red Lion pub.
- Two well proportioned double bedrooms, in addition to two ground floor reception rooms.
- Two ancillary brick built out buildings, ideal for storage or potential conversion.
- No onward chain.



