



7 Eldridge Close, Abingdon

Abingdon

Simpsons
The Pro**active** Agent

Guide Price **£310,000**



Eldridge Close, Abingdon, OX14

Approximate Area = 582 sq ft / 54.1 sq m (excludes store)

For identification only - Not to scale

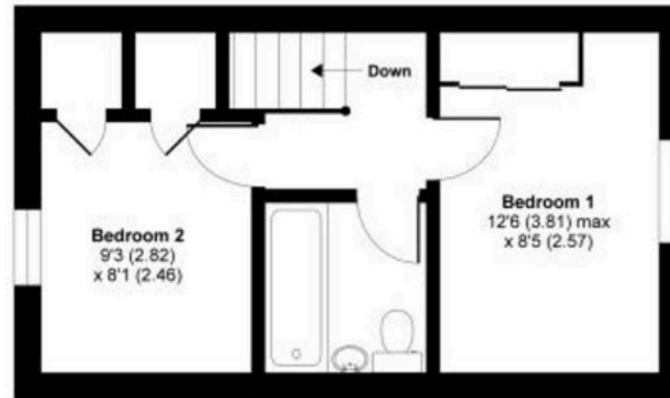

FIRST FLOOR

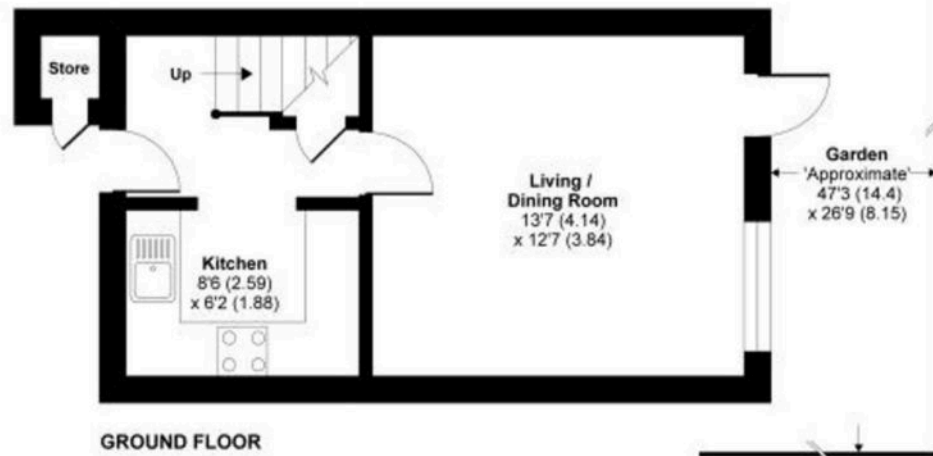

GROUND FLOOR



Floor plan produced in accordance with RICS Property Measurement Standards incorporating International Property Measurement Standards (IPMS2 Residential). © nichescom 2020. Produced for Simpsons Property. REF: 607373.

7 Eldridge Close

Abingdon, Abingdon

This tucked away mid-terraced home has been well looked after and is offered for sale with no onward chain. Ideal for a buy to let investment, or for a first time purchase.

Council Tax band: C

Tenure: Freehold

- Offered for sale with no onward chain.
- Two double bedrooms, both with built-in storage.
- Gas central heating and upvc double glazing.
- Low maintenance garden, mostly laid to lawn with patio areas at either end.
- One allocated parking space in addition to ample on street parking.
- Walking distance to the X1 bus route serving Oxford and Abingdon and to Long Furlong Primary School.



