



64 Sherwood Avenue, Abingdon

Abingdon

Guide Price **£385,000**

Simpsons

The Proactive Agent

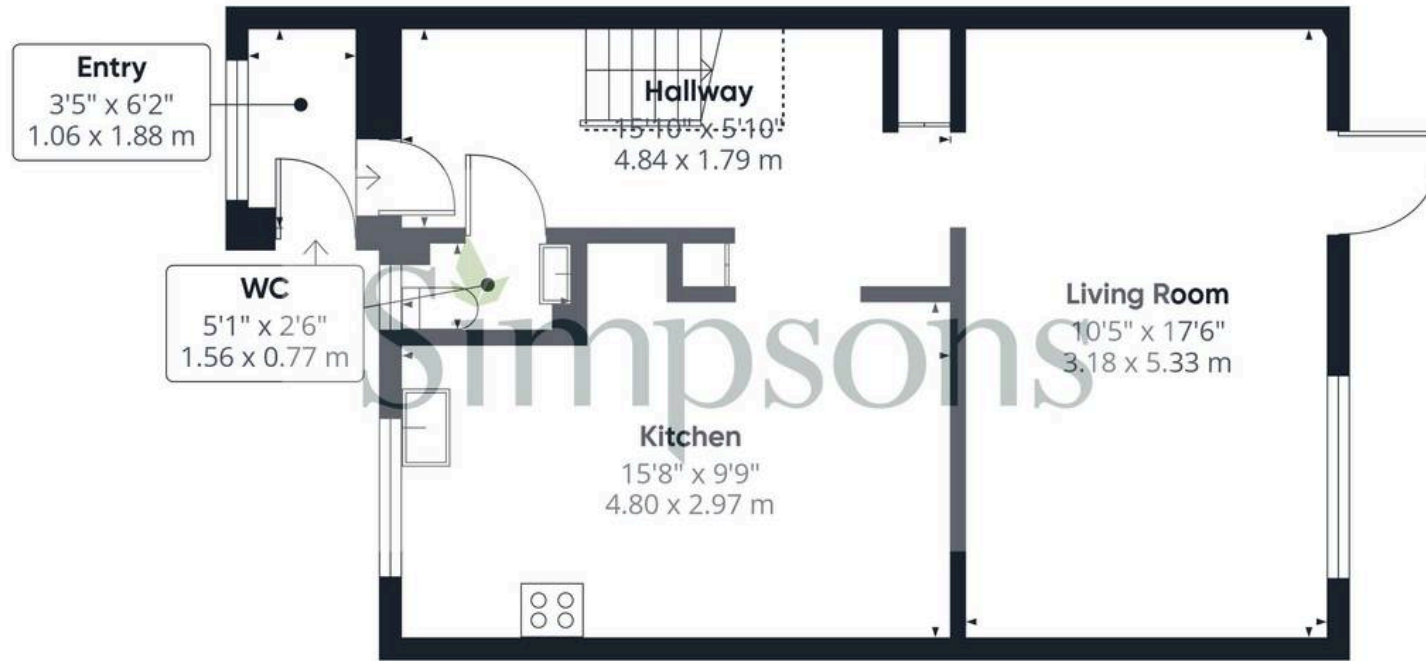

Floor 0



Floor 1

Approximate total area⁽¹⁾

896 ft²

83.1 m²

Reduced headroom

15 ft²

1.4 m²

(1) Excluding balconies and terraces

Reduced headroom

----- Below 5 ft/1.5 m

Calculations reference the RICS IPMS 3C standard. Measurements are approximate and not to scale. This floor plan is intended for illustration only.

64 Sherwood Avenue

Abingdon, Abingdon

Council Tax band: C

Tenure: Freehold

- A spacious open plan kitchen & dining area located to the front of the property.
- A bright living room with French doors onto the private rear garden.
- Downstairs WC
- The private rear garden is mainly laid to lawn with separate seating areas and room for a hot tub.
- Family bathroom
- Three bedrooms, with two generous double bedrooms and the third bedroom making an ideal nursery, office or guest bedroom.



SCAN THE
QR CODE
TO BOOK
YOUR VIEWING

