



15 Hilliat Fields, Drayton

Abingdon

Simpsons
The Pro**active** Agent

In Excess of **£265,000**



**SCAN THE
QR CODE
FOR DETAILS**





Floor 0

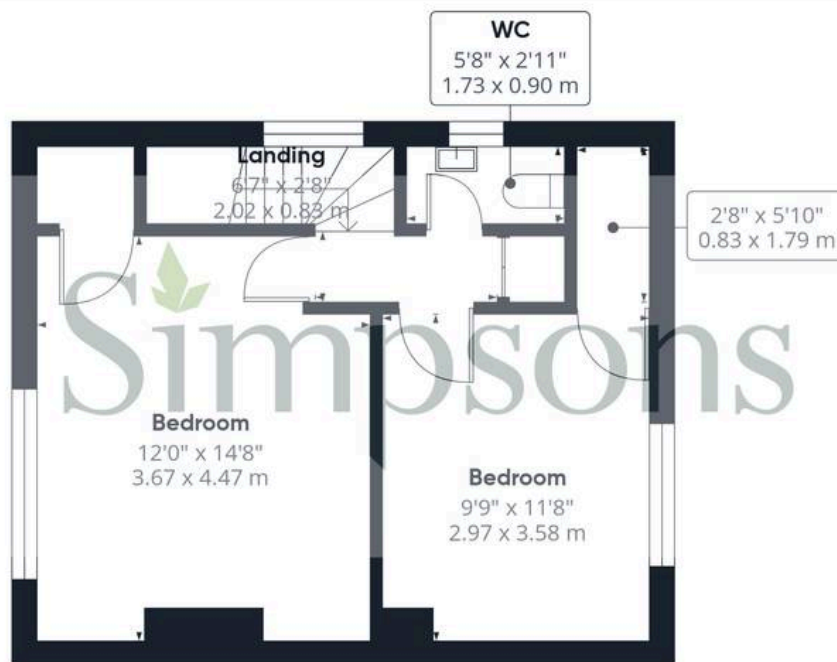

Floor 1

Approximate total area⁽¹⁾

706 ft²

65.6 m²

(1) Excluding balconies and terraces

Calculations reference the RICS IPMS 3C standard. Measurements are approximate and not to scale. This floor plan is intended for illustration only.

GIRAFFE360

15 Hilliat Fields

Drayton, Abingdon

For sale with no onward chain, a charming two bedroom semi detached home offering lots of potential to improve, extend and add value.

Council Tax band: C

Tenure: Freehold

- A pretty, two bedroom semi detached home offering lots of potential to extend, sitting on a significantly larger than average plot with scope to extend and improve the accommodation.
- Located in the village of Drayton, within a short walk of local shops, The Red Lion Pub and bus routes serving Abingdon, Didcot and Oxford City.
- Gas central heating and UPVC double glazing.
- Offered for sale with the certainty of no onward chain.



SCAN THE
QR CODE
TO BOOK
YOUR VIEWING



