



104 Pinnocks Way, Oxford
Oxford

Simpsons
The Proactive Agent

Offers in excess of **£265,000**



**SCAN THE
QR CODE
FOR DETAILS**





Floor 0

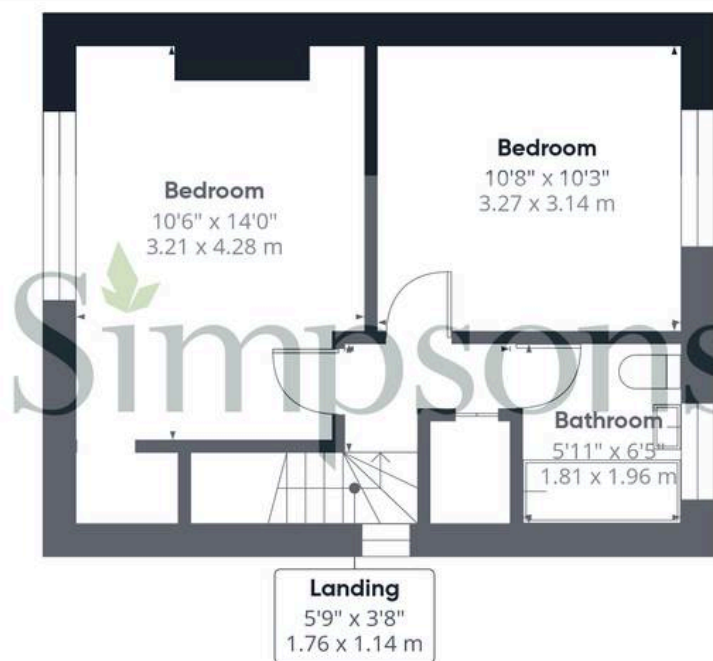

Floor 1

Approximate total area⁽¹⁾

681 ft²

63.2 m²

Reduced headroom

12 ft²

1.1 m²

(1) Excluding balconies and terraces

Reduced headroom

..... Below 5 ft/1.5 m

While every attempt has been made to ensure accuracy, all measurements are approximate, not to scale. This floor plan is for illustrative purposes only.

Calculations are based on RICS IPMS 3C standard.

GIRAFFE360

104 Pinnocks Way

Oxford, Oxford

For sale with no onward chain, this well located home offers scope to extend and improve.

Council Tax band: C

Tenure: Freehold

- Located within walking distance of Botley Centre, a small suburb of Oxford City, this property offers scope to improve and extend, subject to planning permission.
- A very well proportioned rear garden with a brick built outbuilding, ideal for garden storage,
- Two spacious bedrooms in addition to two ground floor reception rooms.
- Gas central heating and UPVC double glazing.
- Driveway parking for two cars, gated side access to the rear garden.
- No onward chain.



SCAN THE
QR CODE
TO BOOK
YOUR VIEWING



