



26 Thorney Leys, Witney



26 Thorney Leys

A fantastic two-bedroom terraced home located on the popular Thorney Leys development within walking distance of all local amenities.

Council Tax band: C

Tenure: Freehold

EPC Energy Efficiency Rating: C

EPC Environmental Impact Rating: C

- A fabulous two-bedroom terraced home located on the popular Thorney Leys development within walking distance of all local amenities.
- Two double bedrooms.
- Modern bathroom with bath and shower.
- Open plan sitting/dining room with french doors leading out to the garden.
- Low maintenance rear-garden with astro-turf and patio.
- Off-street parking space.





Approximate Gross Internal Area
Ground Floor = 27.5 sq m / 296 sq ft
First Floor = 27.2 sq m / 293 sq ft
Total = 54.7 sq m / 589 sq ft



Ground Floor

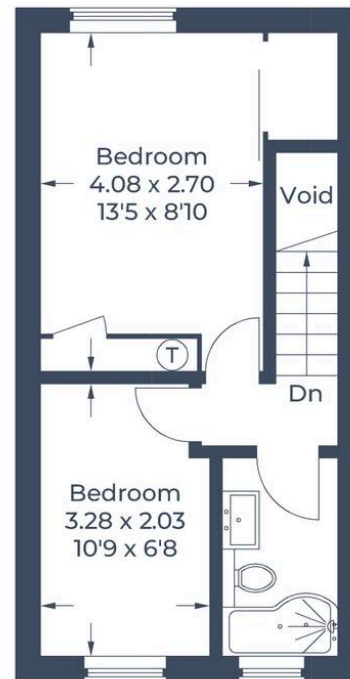

First Floor

Illustration for identification purposes only,
measurements are approximate, not to scale.
© CJ Property Marketing Produced for Simpsons



Simpsons Witney Branch

4 Langdale Court Witney, Oxfordshire - OX28 6AD

01993 835030 • witney@simpsonsproperty.com • www.simpsonsproperty.com/