



28 Olley Crescent, Witney



28 Olley Crescent

A well-presented two-bedroom mid-terrace home located on the popular Windrush development.

Council Tax band: C

Tenure: Freehold

EPC Energy Efficiency Rating: B

EPC Environmental Impact Rating: B

- Offered to the market with no onward chain.
- Well-presented two bedroom mid-terrace home located on the popular Windrush development.
- Open plan kitchen/dining room with French doors leading out to the rear garden.
- Modern bathroom with bath and shower.
- Two double bedrooms.
- Off road parking for two vehicles.





Approximate Gross Internal Area
Ground Floor = 30.8 sq m / 331 sq ft
First Floor = 28.5 sq m / 307 sq ft
Total = 59.3 sq m / 638 sq ft
(Including Void)



Ground Floor

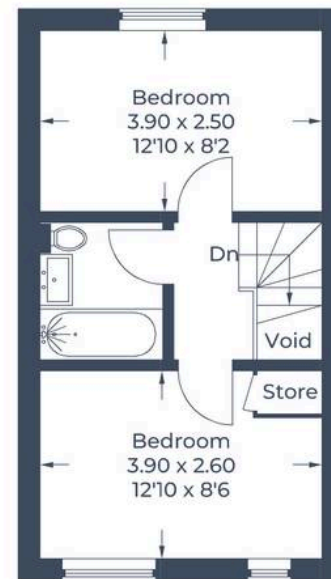

First Floor

Illustration for identification purposes only,
measurements are approximate, not to scale.
© CJ Property Marketing Produced for Simpsons



Simpsons Witney Branch

4 Langdale Court Witney, Oxfordshire - OX28 6AD

01993 835030 • witney@simpsonsproperty.com • www.simpsonsproperty.com/