



15 Dundas Close, Abingdon

Abingdon

Simpsons
The Proactive Agent

£325,000



SCAN THE
QR CODE
FOR DETAILS



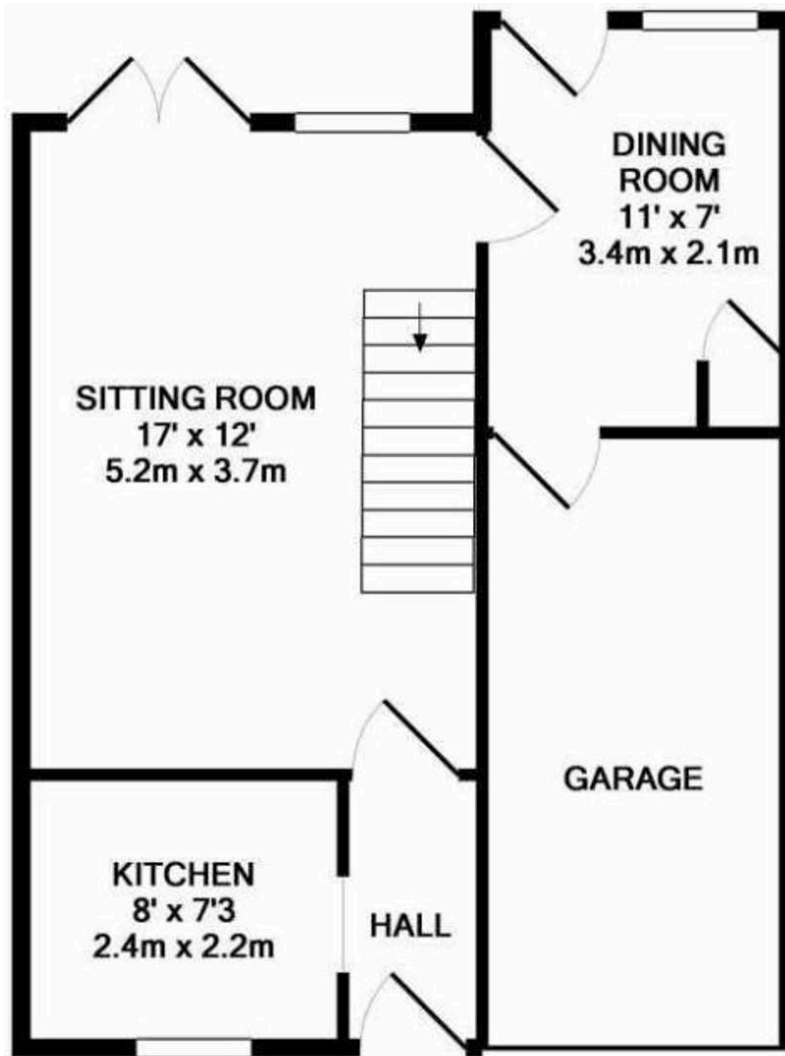

GROUND FLOOR
APPROX. FLOOR
AREA 503 SQ.FT.
(46.7 SQ.M.)

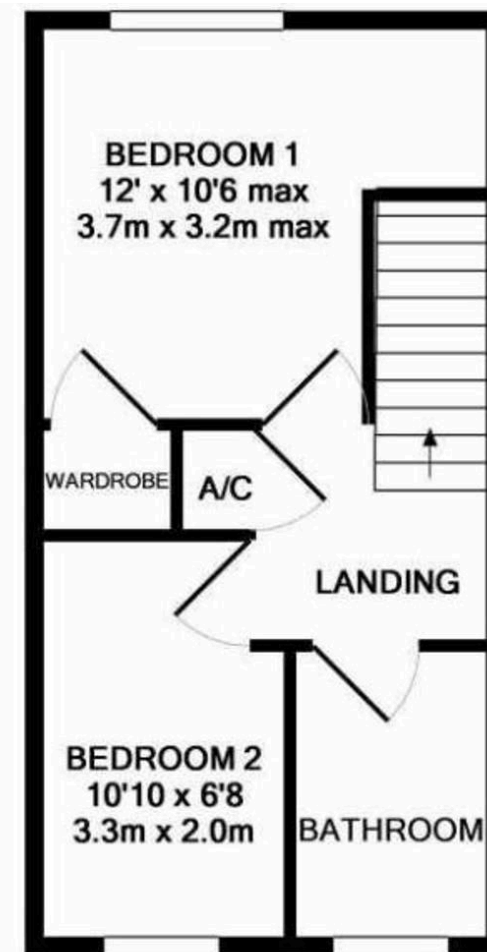

1ST FLOOR
APPROX. FLOOR
AREA 289 SQ.FT.
(26.9 SQ.M.)

TOTAL APPROX. FLOOR AREA 792 SQ.FT. (73.6 SQ.M.)

Whilst every attempt has been made to ensure the accuracy of the floor plan contained here, measurements of doors, windows, rooms and any other items are approximate and no responsibility is taken for any error, omission, or mis-statement. This plan is for illustrative purposes only and should be used as such by any prospective purchaser. The services, systems and appliances shown have not been tested and no guarantee as to their operability or efficiency can be given

Made with Metropix ©2017

15 Dundas Close

Abingdon, Abingdon

Located in a favourable, North Abingdon cul de sac, this well kept home is being offered for sale with no onward chain.

Council Tax band: C

Tenure: Freehold

- Located off Audlett Drive, Dundas Close is a small cul de sac built in the 1980s, being within catchment and walking distance to Thomas Reade Primary School.
- Modern kitchen and bathroom, in addition to a ground floor, rear extension ideal for use as a small dining room or home office/study.
- Sitting room overlooking a well kept rear garden accessed through French Doors.
- Gas central heating and UPVC double glazing.
- The images shown pre-date the current tenancy and although the property remains well presented, should not be used to form a decision to buy, prior to a physical viewing.
- PLEASE NOTE - This property is being sold with vacant possession. At present our client has a tenant in situ on a rolling two month contract.
- PLEASE NOTE - This property is being offered for sale by a relation to one of our members of staff.



SCAN THE
QR CODE
TO BOOK
YOUR VIEWING



