



5 Hanson Road, Abingdon

Abingdon

Simpsons
The Proactive Agent

£600,000



SCAN THE
QR CODE
FOR DETAILS



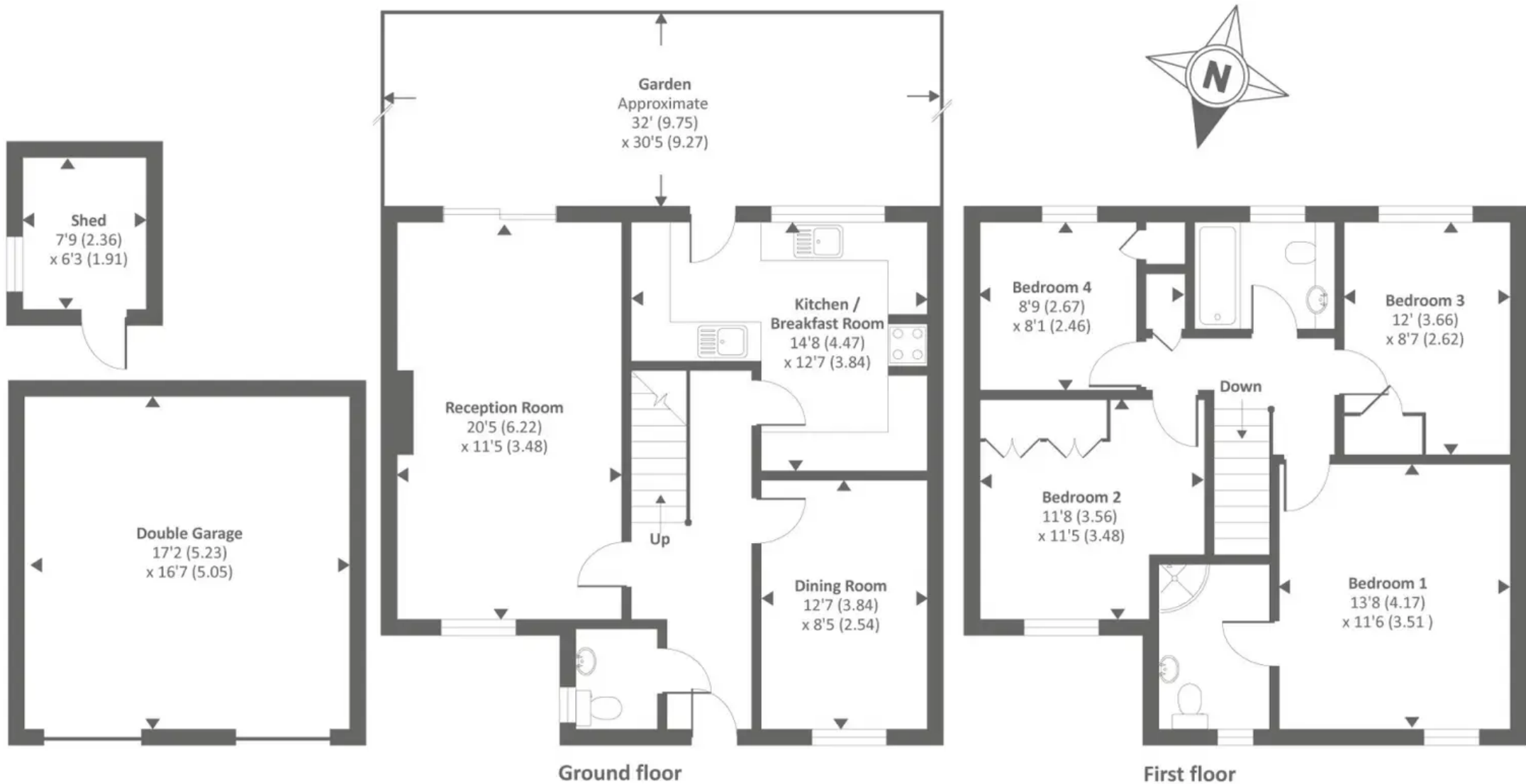

Approx. gross internal floor area 1604 SQFT / 149 SQM (Includes garage & excludes shed)
 Approx. gross external floor area 1923 SQFT / 178.6 SQM

5 Hanson Road

Abingdon, Abingdon

No onward chain! A four double bedroom family home in a prime North Abingdon location.
Council Tax band: F

Tenure: Freehold

- Four double bedroom family home offering well proportioned accommodation.
- Long Furlong Primary School catchment.
- Scope to improve and add value.
- No onward chain.



SCAN THE
QR CODE
TO BOOK
YOUR VIEWING



