



50 Thornley Close, Abingdon

Abingdon

Simpsons
The Proactive Agent

Guide Price £195,000



SCAN THE
QR CODE
FOR DETAILS



Approximate total area⁽¹⁾

485.68 ft²

45.12 m²

(1) Excluding balconies and terraces

While every attempt has been made to ensure accuracy, all measurements are approximate, not to scale. This floor plan is for illustrative purposes only.

Calculations are based on RICS IPMS 3C standard.

GIRAFFE 360

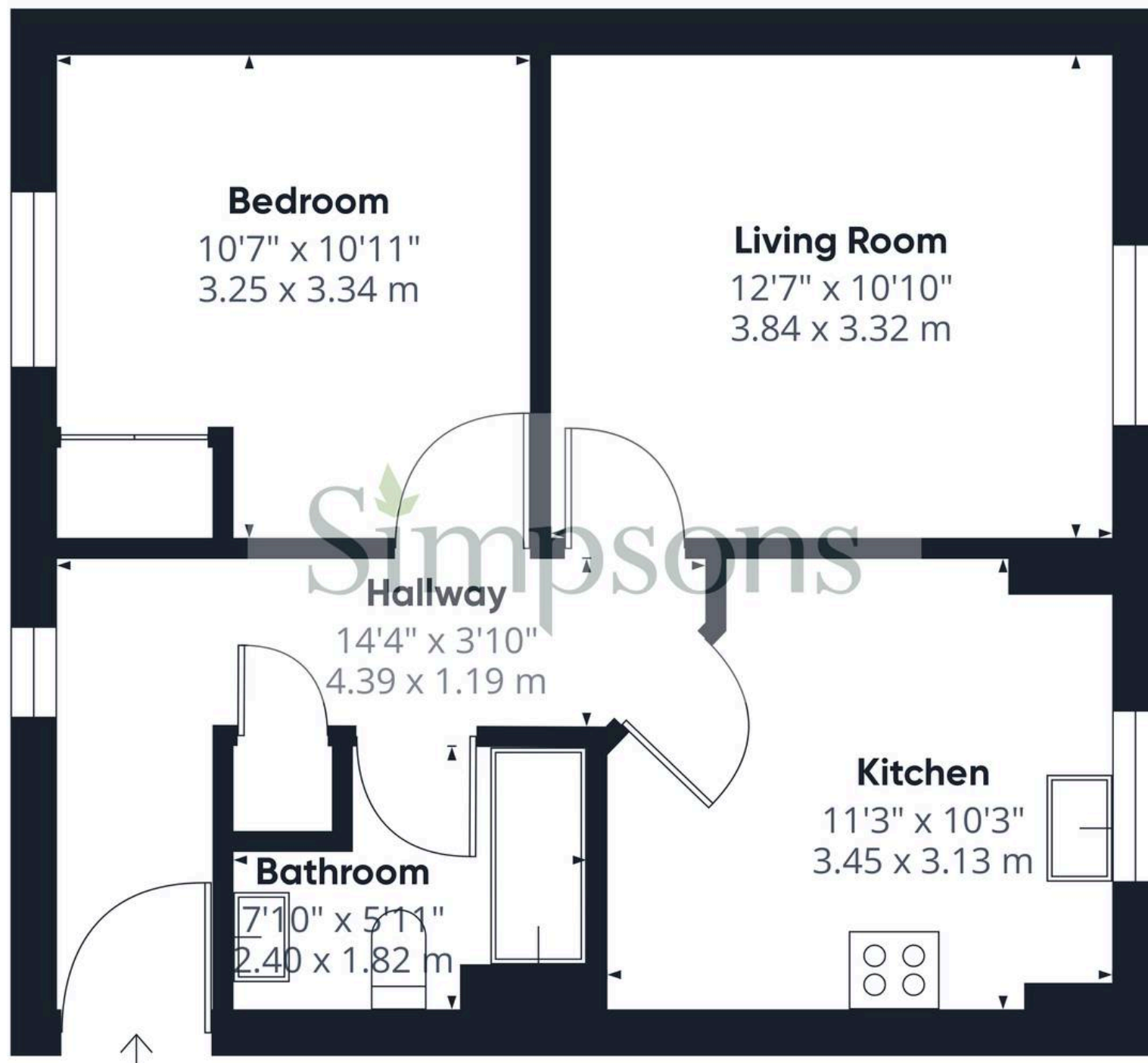

50 Thornley Close

Abingdon, Abingdon

A smart, first floor apartment, located to the West of Abingdon Town Centre, conveniently situated for A34 access.

Council Tax band: B

Tenure: Leasehold

- A first floor, one double bedroom apartment offered for sale in good condition, with the benefit of a recently extended leasehold term (172years).
- Gas central heating and UPVC double glazing.
- Allocated parking for one vehicle.
- Well proportioned kitchen with space for dining table and chairs.
- Entry phone door opening system.
- £0 ground rent, maintenance fee just £97 per month.



SCAN THE
QR CODE
TO BOOK
YOUR VIEWING



