



Columbia Way, Grove

Wantage

Simpsons

The Proactive Agent

Guide Price £280,000



SCAN THE
QR CODE
FOR DETAILS



1 Columbia Way

Approximate Gross Internal Area = 65.2 sq m / 702 sq ft
Garage = 12.8 sq m / 138 sq ft
Total = 78 sq m / 840 sq ft

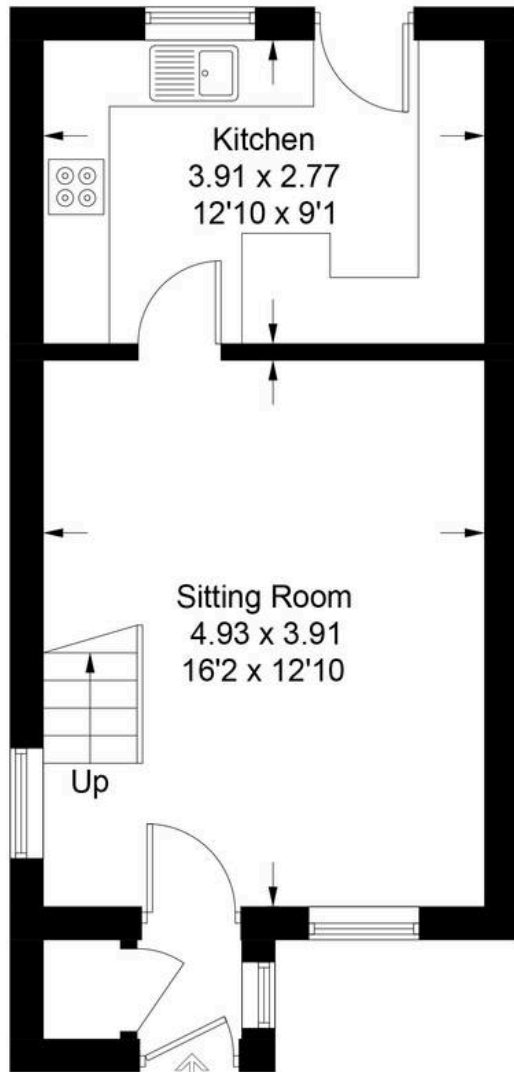

Ground Floor

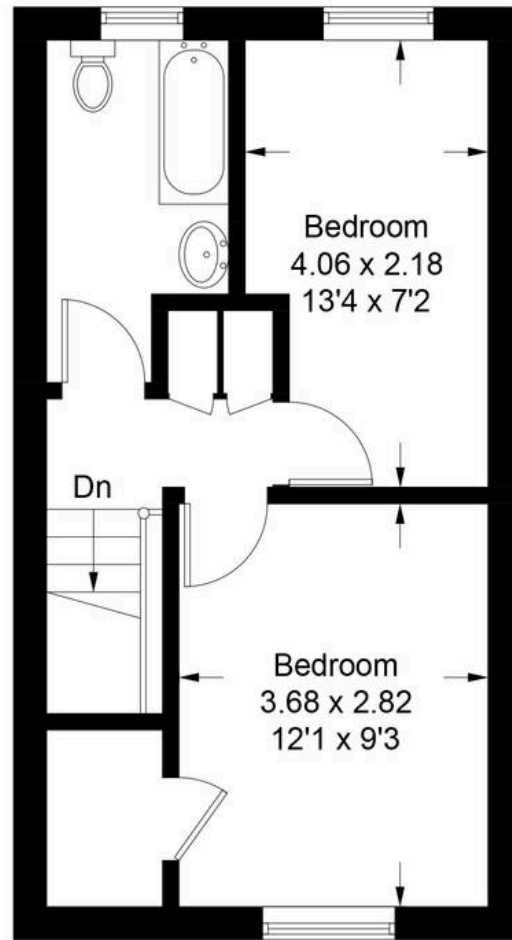

First Floor



(Not Shown In Actual
Location / Orientation)

Columbia Way

Grove, Wantage

Well-presented two bedroom end terrace with an exceptionally large garden and allocated parking. Council Tax band: C

Tenure: Freehold

- Larger Than Average Garden For This Property Type
- Corner Plot With Scope To Extend STP
- Well-Presented Accommodation Throughout
- Garage In A Block With Allocated Parking



SCAN THE
QR CODE
TO BOOK
YOUR VIEWING

