



Cedar Road, Carterton





## Cedar Road

A neatly presented three bedroom terraced townhouse located on a peaceful position on the popular Shilton Park development overlooking the green.

Council Tax band: D

Tenure: Freehold

EPC Energy Efficiency Rating: C

EPC Environmental Impact Rating:

- An extremely versatile terraced townhouse located on the popular Shilton Park development within walking distance of all local amenities.
- Garage and off-street parking space.
- Three double bedrooms, two with built in storage and one with an ensuite.
- Open plan kitchen/dining room with French doors leading to the garden.
- Low maintenance garden laid to lawn with patio.
- Lovely views to the front overlooking the green.



Approximate Gross Internal Area  
 Ground Floor = 38.2 sq m / 411 sq ft  
 First Floor = 37.8 sq m / 407 sq ft  
 Second Floor = 37.8 sq m / 407 sq ft  
 Garage = 14.3 sq m / 154 sq ft  
 Total = 128.1 sq m / 1,379 sq ft



**Ground Floor**

 = Reduced headroom below 1.5m / 5'0

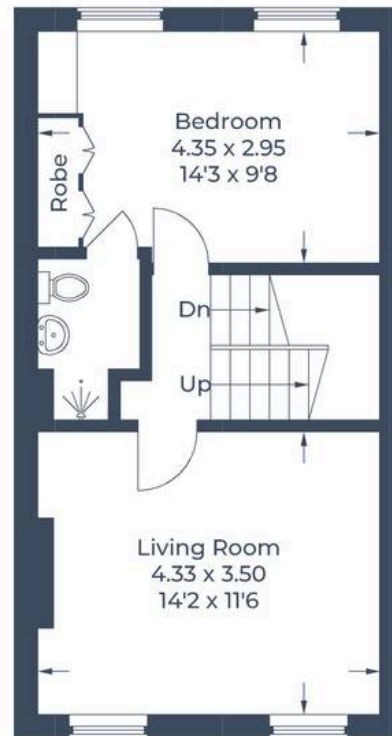

**First Floor**



**Second Floor**



(Not Shown In Actual Location / Orientation)

Illustration for identification purposes only,  
 measurements are approximate, not to scale.





## Simpsons Witney Branch

4 Langdale Court Witney, Oxfordshire - OX28 6AD

01993 835030 • [witney@simpsonsproperty.com](mailto:witney@simpsonsproperty.com) • [www.simpsonsproperty.com/](http://www.simpsonsproperty.com/)