



27 St. Swithuns Road, Kennington  
Oxford

Guide Price £575,000

**Simpsons**  
The Proactive Agent



SCAN THE  
QR CODE  
FOR DETAILS



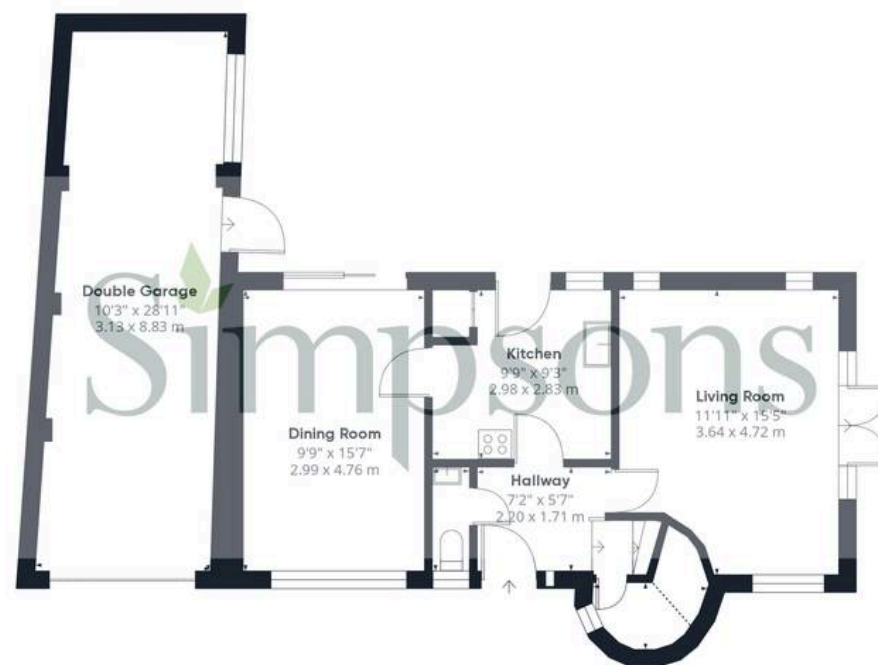

Floor 0

Approximate total area<sup>(1)</sup>

1270.35 ft<sup>2</sup>

118.02 m<sup>2</sup>

Reduced headroom

7.73 ft<sup>2</sup>

0.72 m<sup>2</sup>

(1) Excluding balconies and terraces

Reduced headroom

Below 5 ft/1.5 m

While every attempt has been made to ensure accuracy, all measurements are approximate, not to scale. This floor plan is for illustrative purposes only.

Calculations were based on RICS IPMS 3C standard. Please note that calculations were adjusted by a third party and therefore may not comply with RICS IPMS 3C.

GIRAFFE360

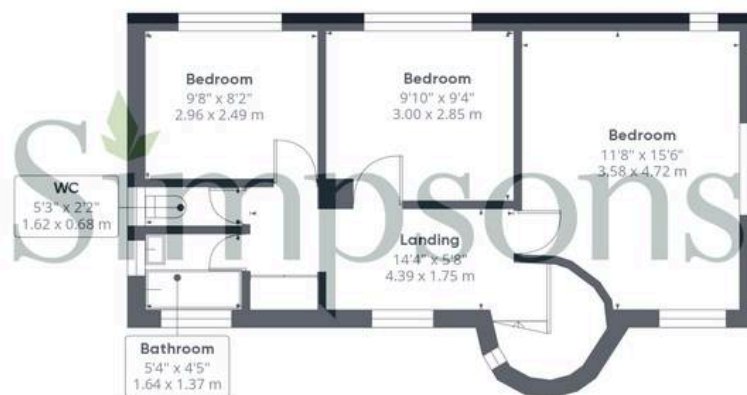

Floor 1



# 27 St. Swithuns Road

Kennington, Oxford

A spacious, and unique family home in a non estate location in the village of Kennington.

Council Tax band: E

Tenure: Freehold

- A unique and spacious family home in a wonderful non estate location on the edge of Bagley Woods, for sale with the certainty of no onward chain.
- Three double bedrooms, two large reception rooms with an interconnecting door between the kitchen and dining room.
- Feature, wooden spiral staircase sitting within a 'turret' style recess.
- The property has been well kept, but is in need of modernisation, offering scope to extend and increase the value.
- Walking distance to St Swithuns Primary School.
- Walking distance to the village shops, The Tandem Pubilc House and the No.35 bus service giving access to Abingdon and Oxford.





