



## 20 Mill Stream Court, Abingdon

Abingdon

**Simpsons**  
The Pro**active** Agent

In Excess of **£183,000**



SCAN THE  
QR CODE  
FOR DETAILS



# Mill Stream Court, Abingdon, OX14

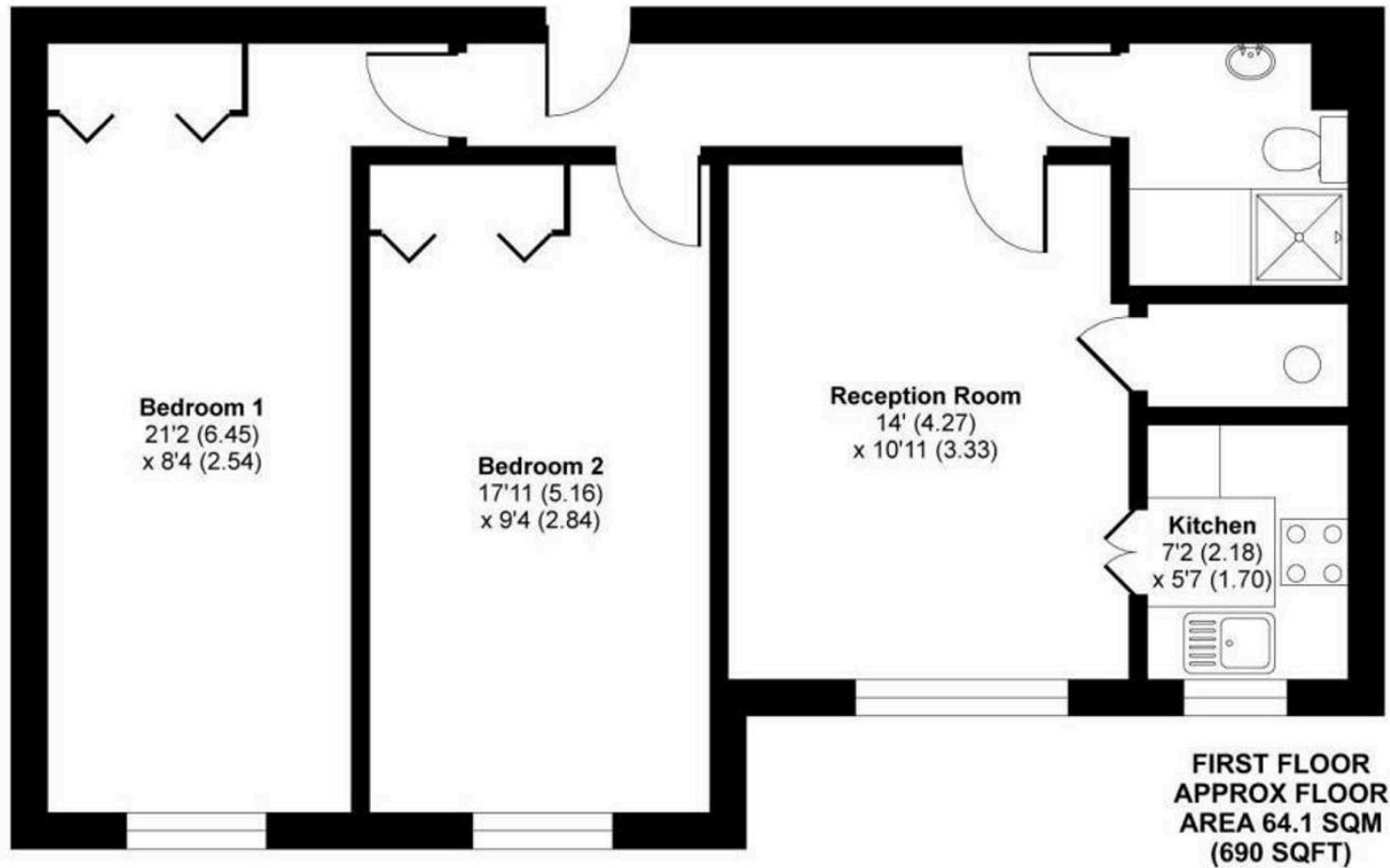

**APPROX. GROSS INTERNAL FLOOR AREA 690 SQ FT 64.1 SQ METRES**

Whilst every attempt has been made to ensure the accuracy of the floor plan contained here, measurements of doors, windows and rooms are approximate and no responsibility is taken for any error, omission or misstatement. These plans are for representation purposes only as defined by RICS Code of Measuring Practice and should be used as such by any prospective purchaser. Specifically no guarantee is given on the total square footage of the property if quoted on this plan. Any figure given is for initial guidance only and should not be relied on as a basis of valuation.



# 20 Mill Stream Court

Abingdon, Abingdon

A larger design, two double bedroom retirement apartment set in beautiful, riverside gardens.

Council Tax band: D

Tenure: Leasehold

- A spacious, first floor retirement apartment within a short walk of Abingdon Town Centre.
- Well proportioned accommodation including two spacious, versatile double bedrooms.
- 98 year leasehold term, £4,146 per year maintenance/service charge, £292 per year ground rent.
- Beautifully kept, regularly maintained riverside gardens with a patio/terrace accessed from the developments resident lounge.
- Lift access to all floors.
- Secure ground floor entrance with intercom access to each property.



SCAN THE  
QR CODE  
**TO BOOK**  
YOUR VIEWING

