



40 Francis Little Drive, Abingdon

Abingdon

Simpsons
The Proactive Agent

Guide Price £345,000



SCAN THE
QR CODE
FOR DETAILS



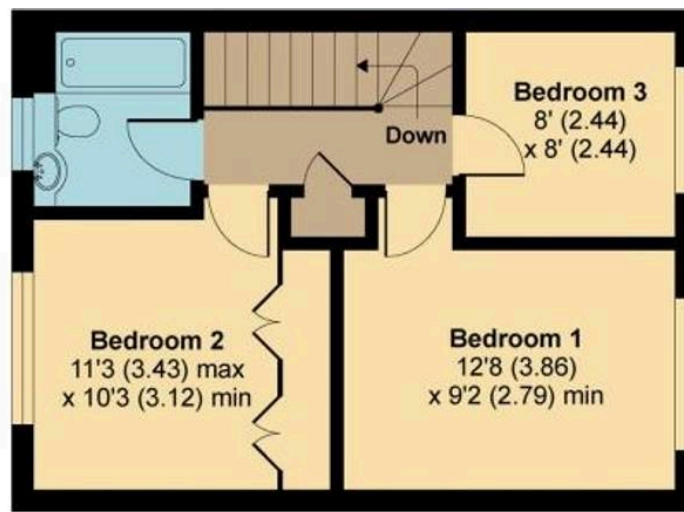

FIRST FLOOR

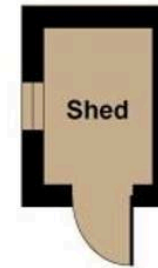
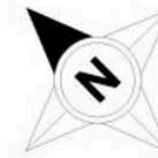

OUTBUILDING

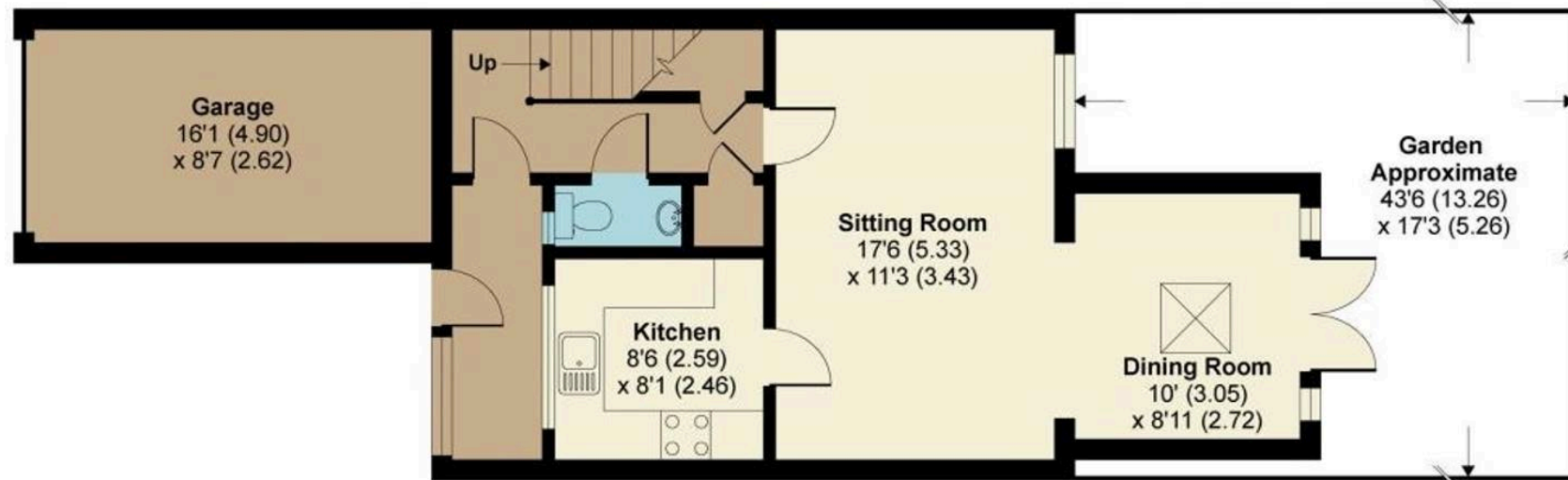

GROUND FLOOR

Francis Little Drive, Abingdon, OX14 5PN

MAIN HOUSE APPROX. GROSS INTERNAL FLOOR AREA 956 SQ FT 88.8 SQ METRES
 GARAGE APPROX. GROSS INTERNAL FLOOR AREA 146 SQ FT 13.5 SQ METRES
 OUTBUILDING APPROX. GROSS INTERNAL FLOOR AREA 25 SQ FT 2.3 SQ METRES
 TOTAL APPROX. GROSS INTERNAL FLOOR AREA 1127 SQ FT 104.6 SQ METRES

40 Francis Little Drive

Abingdon, Abingdon

A well kept family home, located in South Abingdon on the Poets Development.

Council Tax band: D

Tenure: Freehold

- A very well kept, extended family home offering a partially open plan ground floor layout.
- UPVC double glazing and gas central heating (new boiler in 2019)
- Downstairs WC.
- Refitted bathroom and kitchen.
- Walking distance to Carswell Primary School and Larkmead Secondary School.
- Potential to convert the garage space into a home office or fourth bedroom.



SCAN THE
QR CODE
TO BOOK
YOUR VIEWING



