



## 8 Woodrush Gardens, Carterton

Guide Price £315,000



## 8 Woodrush Gardens

A neatly presented three-bedroom end of terrace home located on the popular Shilton Park development within walking distance of local amenities including shops, primary and secondary schools.

Council Tax band: C

Tenure: Freehold

EPC Energy Efficiency Rating: C

EPC Environmental Impact Rating: C

- Neatly presented three-bedroom end of terrace home.
- Garage and two parking spaces.
- Bedroom one with ensuite and built in cupboards.
- Attractive, landscaped gardens.
- Within walking distance of the town centre offering shops, supermarkets, restaurants, pubs, primary and secondary schools.
- Ideal opportunity for someone looking for a family home.

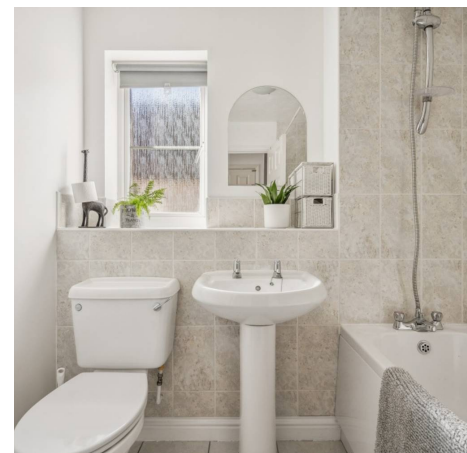

Approximate Gross Internal Area  
Ground Floor = 38.6 sq m / 415 sq ft  
First Floor = 38.3 sq m / 412 sq ft  
Garage = 13.9 sq m / 150 sq ft  
Total = 90.8 sq m / 977 sq ft

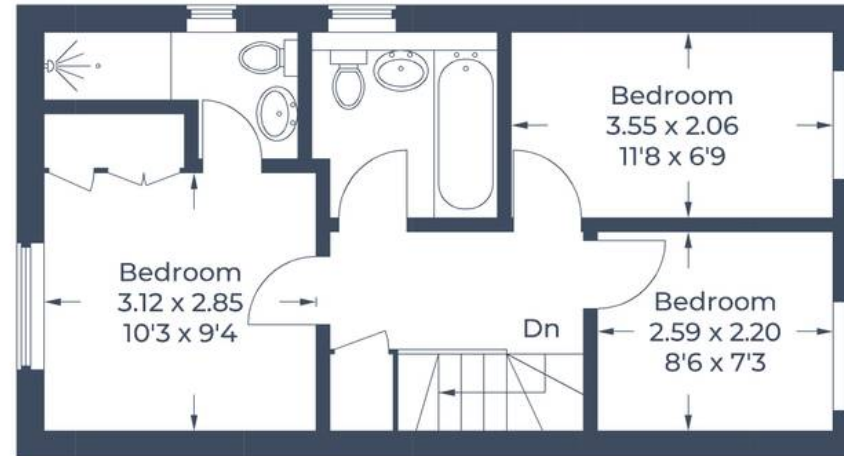

**First Floor**



**Ground Floor**

Illustration for identification purposes only,  
measurements are approximate, not to scale.

© CJ Property Marketing



## Simpsons Witney Branch

4 Langdale Court, Witney - OX28 6AD

01993 835030 • [witney@simpsonsproperty.com](mailto:witney@simpsonsproperty.com) • [www.simpsonsproperty.com/](http://www.simpsonsproperty.com/)