



60 Manor Road, Witney

Guide Price £270,000



60 Manor Road

A well presented two-bedroom terraced home located within a short walk of the town centre on the sought-after Cogges development.

Council Tax band: C

Tenure: Freehold

EPC Energy Efficiency Rating: C

EPC Environmental Impact Rating: D

- An ideal property for first-time buyers or investors.
- Two double bedrooms, both with built in wardrobes.
- Carport with additional off-street parking space.
- Popular location within Cogges.
- Sitting room with French doors leading to the recently updated rear garden.
- Located a short walk from the town centre.

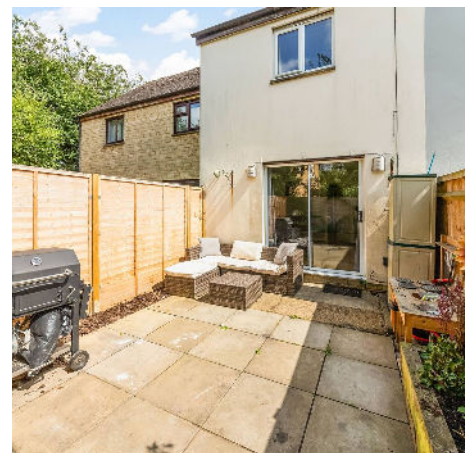



Manor Road, OX28

Approximate Gross Internal Area = 55.5 sq m / 597 sq ft

For identification only - Not to scale

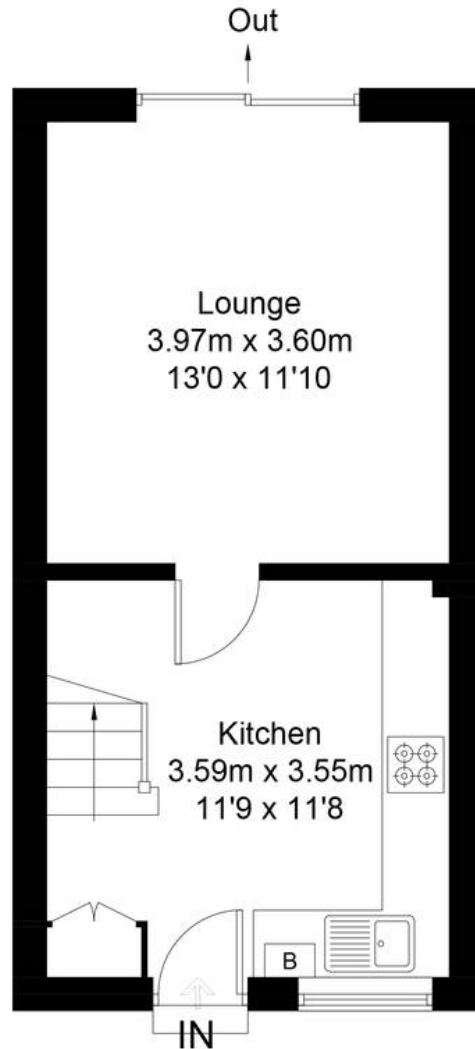

Ground Floor

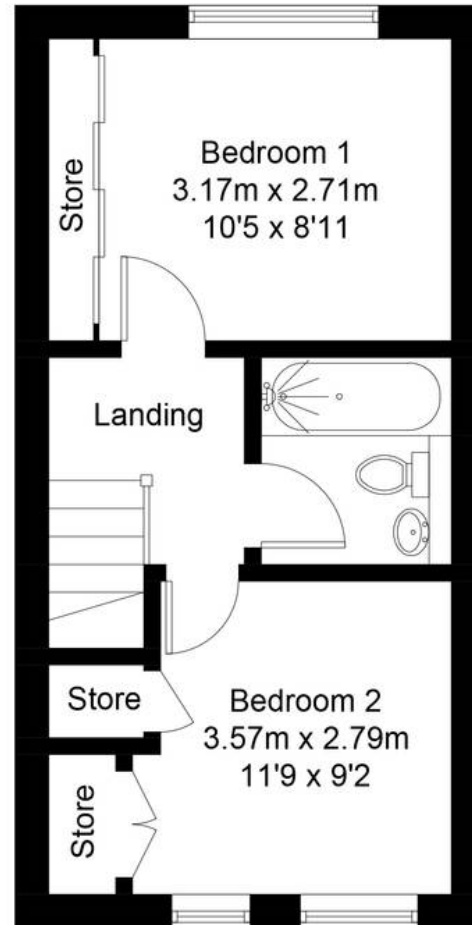

First Floor

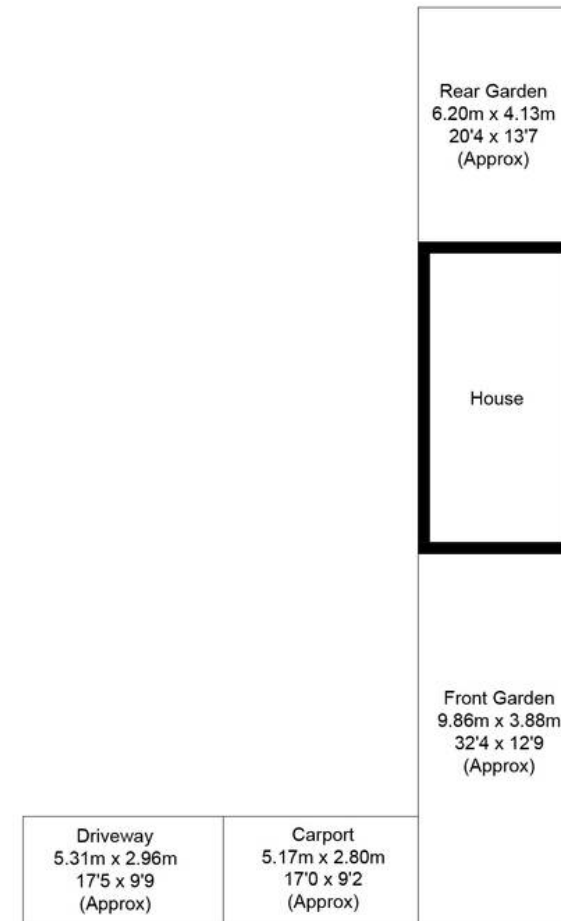



Simpsons Witney Branch

4 Langdale Court, Witney - OX28 6AD

01993 835030 • witney@simpsonsproperty.com • www.simpsonsproperty.com/