



34 Hanborough Close, Eynsham

Guide Price £415,000

34 Hanborough Close

A neatly presented three bedroom end of terrace house offering incredibly versatile accommodation to a purchaser.

Council Tax band: C

Tenure: Freehold

EPC Energy Efficiency Rating: C

EPC Environmental Impact Rating: C

- A neatly presented three bedroom end of terrace house situated in the heart of this popular village within walking distance of shops, pubs and the local 'Outstanding' Ofsted rated secondary school.
- The home offers incredibly versatile accommodation and benefits from three reception rooms plus a large outdoor hobby room/workshop.
- Ground floor shower room.
- Landscaped rear garden with mature trees and shrubs.
- Three double bedrooms
- Fantastic access to the A40 for commuting.





Hanborough Close, OX29

Approximate Gross Internal Area = 115.8 sq m / 1246 sq ft

Sheds = 23.8 sq m / 256 sq ft

For identification only - Not to scale

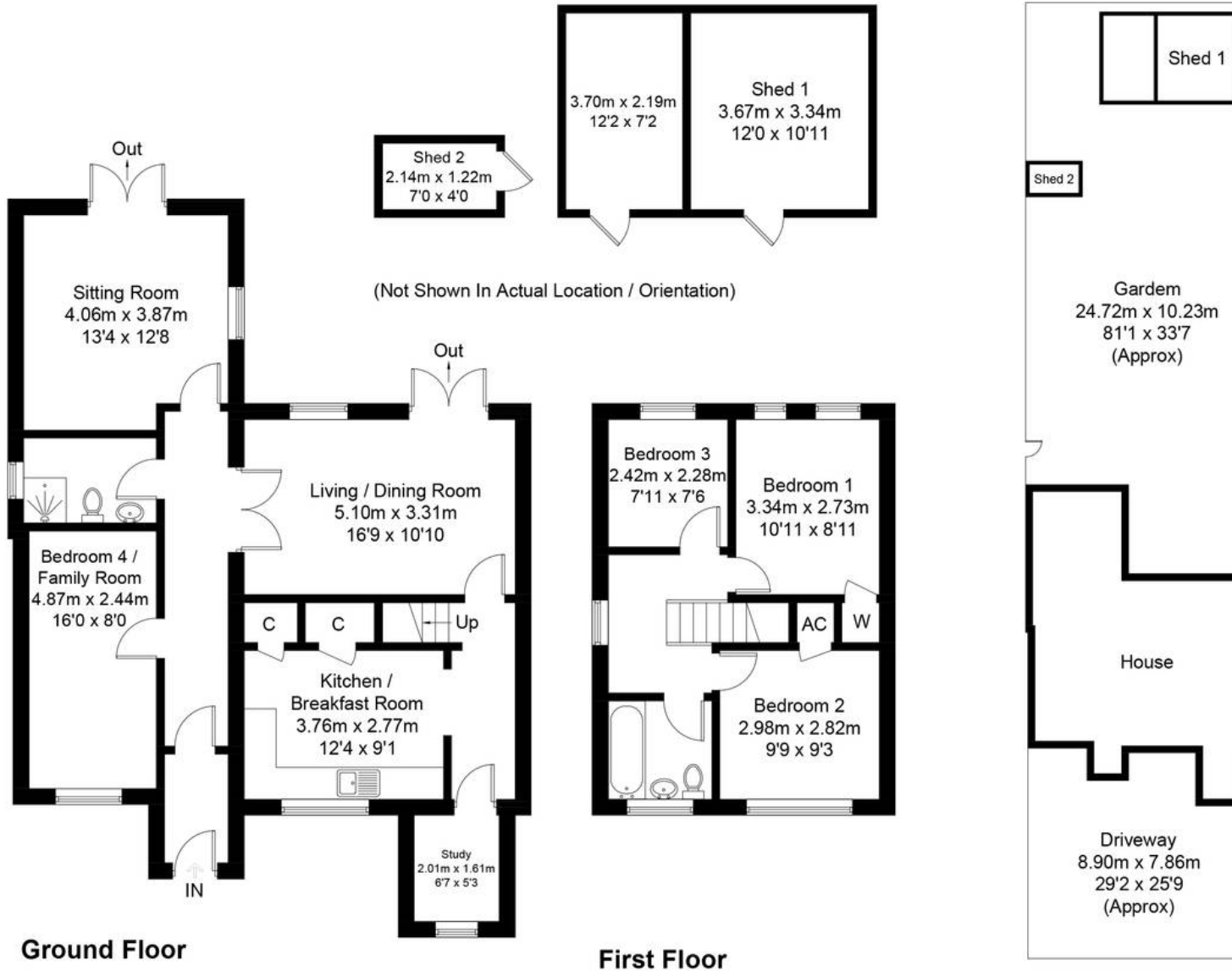



Simpsons Witney Branch

4 Langdale Court, Witney - OX28 6AD

01993 835030 • witney@simpsonsproperty.com • www.simpsonsproperty.com/